

	PAGE
Introduction	3
General	4
Finder guide.....	5-6
BNC 50 Ω	
Interface	7
Characteristics.....	8-10
Straight plugs.....	11
Right-angle plugs	12
Straight jacks	13
Flange jacks	14
Bulkhead jacks	15
Flange receptacles	16
Bulkhead receptacles	17
Panel receptacles	18
PCB receptacles	19
In series adapters	20-21
Caps	22
BNC 75 Ω	
Characteristics.....	23-24
Straight plugs.....	25
Right-angle plugs	26
Jacks	27
Bulkhead jacks	28
Panel receptacles	29
PCB receptacles	30
In series adapters	30-31
Additional connectors	32-33
Panel drilling.....	34-35
Assembly instructions	36-50

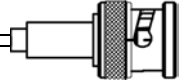

The BNC connector, the most popular coaxial connector series in the world, features a two-pin bayonet coupling system for quick and reliable engagement and disengagement.

● **Wide range :**

RADIALL's BNC connectors are available with two characteristic impedances 50 Ω and 75 Ω; and, they are completely intermateable with one another.

The BNC range offers cable connectors for both flexible or semi-rigid cables, panel and PCB mount receptacles including press mount, through hole and press fit pins connectors. In series adapters and between series adapters including PUSH-ON type are also available (please look at adapters section).

RADIALL also offers you a low cost range called commercial BNC, whose characteristics are compared to those of the standard BNC in the chart here under.

● **Convenient 3-piece design :**

A range of crimp type cable connectors (straight and right angle models) features :

a 3 piece design : single piece body + center contact + outer ferrule,

You can find them with the "single piece body" mention on note.

● **Fast and reliable cable attachment**

The cable connectors can be either fully crimped or soldered/crimped, offering full flexibility for high volume production with standard manual or pneumatic tooling : fast and reliable.

- ◆ the center contact can be either crimped or soldered,
- ◆ the outer contact is attached to the cable by crimping a ferrule.

	Standard BNC		Commercial BNC	
Applications	<ul style="list-style-type: none"> ◆ Military Telecommunications ◆ Civil Telecommunications ◆ Measurement and instrumentation ◆ General electronics 		<ul style="list-style-type: none"> ◆ Civil Telecommunications ◆ Datacommunications ◆ Measurement and instrumentation ◆ Broadcast application ◆ Security & video systems ◆ Antennas ◆ Automotive industry ◆ General electronics 	
Impedance	50 Ω	75 Ω	50 Ω	75 Ω
Codification	R141 XXX XXX	R142 XXX XXX	R141 XXX 161	R142 XXX 161
Frequency range	DC - 4 GHz	DC - 1 GHz	DC - 1.5 GHz	
Temperature range	- 65°C / + 165°C		-35°C / + 70°C	
Durability	500 matings		100 matings	
Coupling nut	Cross knurl		Straight knurl	
Material Coupling nut Insulator Female center contact	Brass PTFE Beryllium copper		Die cast zinc Polypropylen Brass	

Radiall also offers a complete range of MICROWAVE COMPONENTS : terminations, attenuators, etc. designed around the BNC interface.

For further details, please ask for our :

- Between series adapters see adapters section.

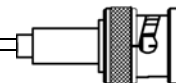

50 Ω	DC - 4 GHz DC - 1.5 GHz (commercial)
75 Ω	DC - 1 GHz DC - 1.5 GHz (commercial)

GENERAL

- Worldwide standardised coaxial connectors
- Bayonet coupling
- Proven strength and reliability
- Good RF performance
- 2 ranges : **BNC 50 Ω**
BNC 75 Ω
- Commercial BNC
- Safety BNC (please consult RADIALL)

APPLICABLE STANDARDS

- MIL-C-39012 / MIL STD 348-A/301
- IEC 169-8
- CECC 22120
- NF-C-93564 KBN series
- UTE-C-93564

APPLICATIONS

- Civil and military radio-telecommunication equipment
- Test and measurement
- Videocommunication
- Computer network
- Industrial network
- General electronics

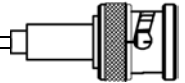

CABLE CONNECTORS

R141 xxx 161
 ↓ ↓
 BNC 50 Ω commercial

R142 xxx 161
 ↓ ↓
 BNC 75 Ω commercial

Model Cable	Straight plug		Right-angle plug		Straight jack		Square flange straight jack		Bulkhead straight jack	
	Crimp and full crimp	Clamp	Crimp and full crimp	Clamp	Crimp and full crimp	Clamp	Crimp and full crimp	Clamp	Crimp and full crimp	Clamp
2/50/S (RG 178)		R141 003 000 (page 11)						R141 253 000 (page 14)	R141 301 000 (page 15)	R141 323 000 (page 15)
2.6/50/S (RG 316)	R141 075 000 R141 075 161 (page 11)	R141 004 000 (page 11)	R141 181 161 (page 12)	R141 154 000 (page 12)	R141 217 000 (page 13)		R141 290 200 (page 14)	R141 254 000 R141 277 000 R141 278 000 (page 14)	R141 306 000 R141 306 503 R141 331 500 (page 15)	R141 304 000 R141 324 000 (page 15)
2.6/50/D (RD 316)		R141 004 000 (page 11)		R141 154 000 (page 12)				R141 254 000 R141 277 000 R141 278 000 (page 14)		R141 304 000 R141 324 000 (page 15)
2.6/75/S	R142 076 000 R142 076 161 (page 25)	R142 004 000 (page 25)		R142 154 000 (page 26)	R142 217 000 (page 27)			R142 202 000 (page 27)	R142 306 500 R142 306 503 R142 306 520 R142 331 011 (page 28)	
3.8/93/S	R142 078 161 (page 25)									
5/50/S (RG 58)	R141 072 000 R141 082 000 R141 082 161 (page 11)	R141 007 161 R141 009 000 R141 010 000 (page 11)	R141 182 161 (page 12)	R141 156 000 (page 12)	R141 237 000 R141 237 161 (page 13)	R141 207 000 R141 208 000 (page 12)	R141 292 000 (page 14)	R141 256 000 R141 258 000 R141 259 000 (page 14)	R141 308 000 R141 332 500 R141 332 161 (page 15)	R141 327 000 (page 15)
5/50/D (RG 142)	R141 083 000 (page 11)	R141 007 161 R141 009 000 R141 010 000 (page 11)	R141 182 000 R141 183 000 (page 12)	R141 156 000 (page 12)	R141 220 000 (page 13)	R141 207 000 R141 208 000 (page 13)	R141 297 000 (page 14)	R141 256 000 R141 258 000 R141 259 000 (page 14)		R141 327 000 (page 15)
5/75/D	R142 083 000 (page 25)									
6/75/S (RG 59)	R142 085 000 R142 085 161 (page 25)	R142 016 000 R142 016 161 (page 25)	R142 184 000 R142 184 161 (page 26)	R142 157 000 (page 26)	R142 242 000 R142 242 161 (page 27)		R142 295 000 R142 295 161 (page 27)	R142 268 000 (page 27)	R142 334 161 (page 28)	R142 329 000 (page 28)
8/75/S		R142 017 000 (page 25)								
10 + 11/50		R141 018 000 (page 11)								
10 + 11/75	R142 095 000 (page 25)	R142 018 000 (page 25)								
.141" (RG 402)		R141 052 000 (page 11)								

CAPS

Model	Free	Cord	Chain	Short-circuit chain
M	R141 802 000 (page 22)	R141 805 000 (page 22)	R141 812 000 (page 22)	R141 862 000 (page 22)
F			R141 842 000 (page 22)	

ATTENTION ! This guide is intended as an information and does not include all BNC SERIES P/N

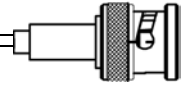

RECEPTACLES

R141 xxx 161
 ↓ ↓
 BNC 50 Ω commercial

R142 xxx 161
 ↓ ↓
 BNC 75 Ω commercial

Model	Straight female flange		Right-angle female flange	Straight female bulkhead		Straight male flange	Straight male bulkhead	Press mount receptacle	PCB receptacles			
	Square	2 hole	Square	Front mount	Right angle	Square	Front mount	Straight	Straight	Right angle	Bulkhead right angle	
Solder contact with solder pot	R141 403 000 R141 403 500 R141 404 000 R141 406 000 R141 407 000 (page 16) R142 407 000 R142 412 000 (page 29)	R141 453 000 (page 16)	R141 653 000 R141 654 000 (page 16)	R141 554 000 R141 557 000 R141 559 000 R141 572 000 R141 574 000 R141 6xx 000 R141 563 161 R141 554 161 (page 17) R141 574 161 R142 562 000 R142 562 290 (page 29)	R141 680 000 (page 17)	R141 440 000 (page 18)	R141 580 000 (page 18) R142 580 000 (page 29)					
Solder cylindrical contact								R141 500 200 (page 18)				
Solder pins (standard space)									R141 426 000 R141 426 161 R141 426 165 (page 19) R142 426 030 R142 426 161 (page 30)	R141 665 000 R141 665 030 R141 665 161 (page 19)	R141 676 423 R141 676 433 (page 19)	
Solder pins (reduced space)									R141 508 200 (page 19)			
Press fit pins									R141 416 000 (page 19)		R141 684 130 (page 19)	

IN-SERIES ADAPTERS

Model	Straight	Straight bulkhead	Straight flange	Right-angle	Tee	Cross
M - M	R141 703 000 (page 20) R142 703 000 (page 30)					
F - F	R141 704 000 (page 20) R142 704 000 (page 30)	R141 720 000 R141 723 000 R141 730 000 R141 753 000 R141 720 161 R141 723 161 (page 20) R142 720 161 R142 720 000 R142 723 000 (page 30)	R141 710 000 R141 717 000 (page 20) R142 710 000 (page 30)			
M - F				R141 770 000 (page 20) R142 770 000 (page 30)		
F - F / M					R141 780 000 R141 789 000 (page 21) R142 780 000 R142 789 000 (page 31)	
F - F / F					R141 782 000 (page 21) R142 782 000 (page 31)	
M - F - F / F						R141 799 000 (page 21)

ATTENTION ! This guide is intended as an information and does not include all BNC SERIES P/N

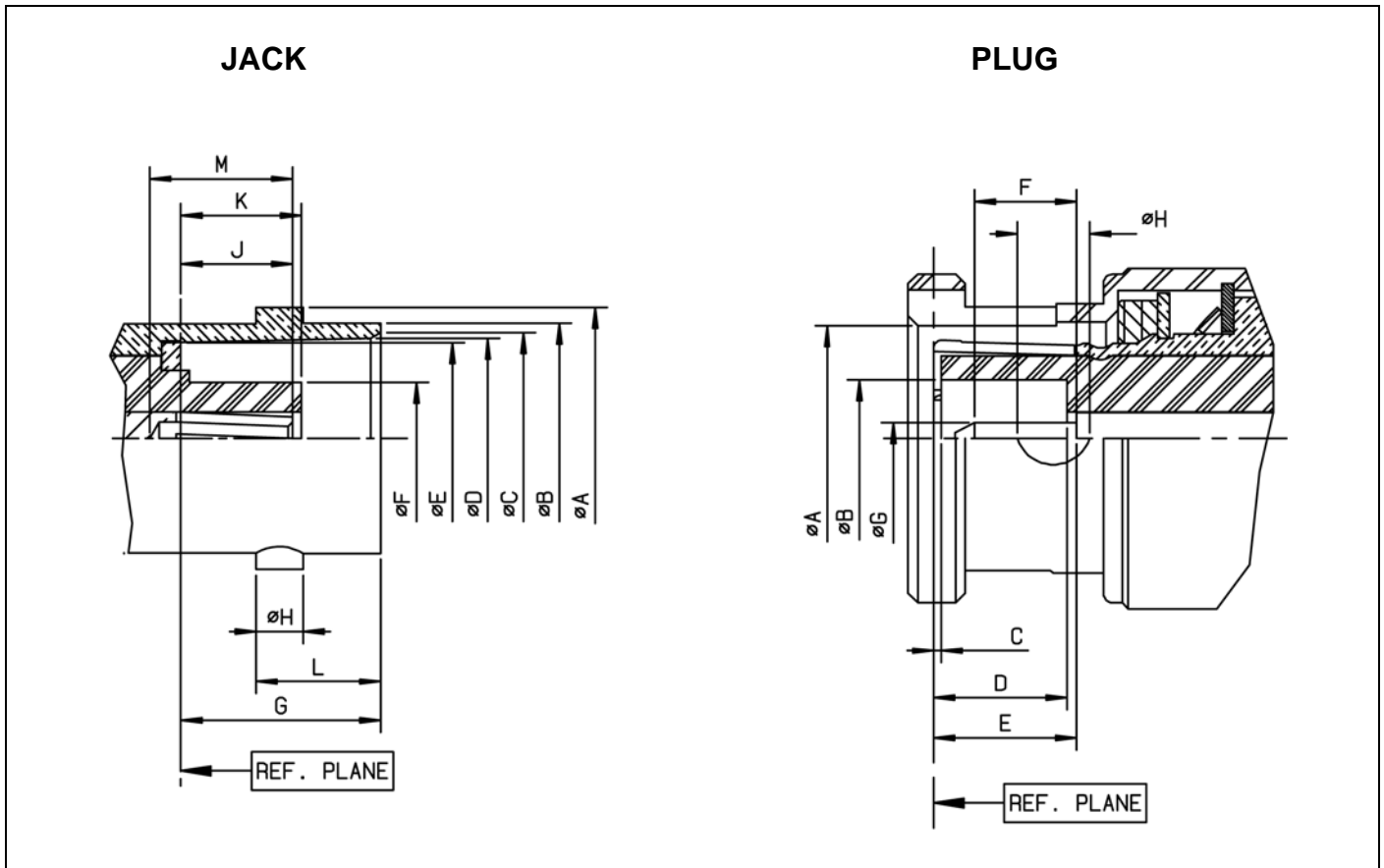
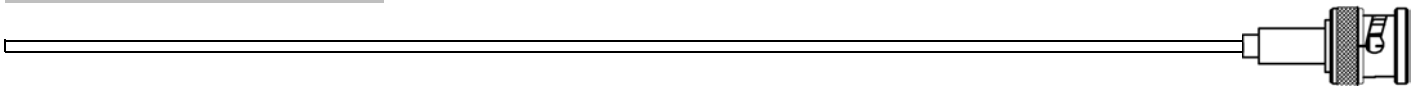

LETTER	mm		inch	
	min.	max.	min.	max.
A DIA	10.97	11.07	.432	.436
B DIA	9.60	9.70	.378	.382
C DIA	8.79	9.04	.346	.356
D DIA	8.31	8.46	.327	.333
E DIA	8.10	8.15	.319	.321
F DIA	-	4.72	-	.186
G	8.31	8.51	.327	.335
H	1.91	2.06	.075	.081
J	4.72	5.23	.186	.206
K	4.78	5.28	.188	.208
L	5.18	5.28	.204	.208
M	4.95	-	.195	-

LETTER	mm		inch	
	min.	max.	min.	max.
A DIA	9.78	9.91	.385	.390
B DIA	4.83	-	.190	-
C	0.15	-	.006	-
D	5.28	5.79	.208	.228
E	5.33	5.84	.210	.230
F	1.98	-	.078	-
G DIA	1.32	1.37	.052	.054
H DIA	2.31	2.46	.091	.097

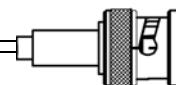

TEST/CHARACTERISTICS	STANDARD REFERENCE	VALUES/REMARKS
----------------------	--------------------	----------------

ELECTRICAL CHARACTERISTICS

TEST/CHARACTERISTICS	STANDARD REFERENCE	VALUES/REMARKS												
Impedance		50 Ω												
Frequency range		DC - 4 GHz												
Typical V.S.W.R. • <i>Straight models cable group</i> : 2/50, 2.6/50, 5/50, 10 + 11/50, .141" • <i>Right angle models</i> :		<table border="1"> <thead> <tr> <th>1 GHz</th> <th>2.5 GHz</th> <th>4 GHz</th> </tr> </thead> <tbody> <tr> <td>1.12</td> <td>1.18</td> <td>1.22</td> </tr> <tr> <td>1.13</td> <td>1.30 max</td> <td>1.22</td> </tr> <tr> <td></td> <td>1.20</td> <td></td> </tr> </tbody> </table>	1 GHz	2.5 GHz	4 GHz	1.12	1.18	1.22	1.13	1.30 max	1.22		1.20	
1 GHz	2.5 GHz	4 GHz												
1.12	1.18	1.22												
1.13	1.30 max	1.22												
	1.20													
Insertion loss	straight connector right-angle connector	<table border="1"> <thead> <tr> <th>0.05</th> <th>0.07</th> <th>0.13</th> </tr> </thead> <tbody> <tr> <td>0.08</td> <td>0.16</td> <td>0.20</td> </tr> </tbody> </table>	0.05	0.07	0.13	0.08	0.16	0.20						
0.05	0.07	0.13												
0.08	0.16	0.20												
RF Leakage		- 55 dB min from 2 to 3 GHz												
Insulation resistance		5000 MΩ min												
Contact resistance	center contact outer contact	1.5 mΩ 0.2 mΩ												
Working voltage in VRMS	at sea level (at 21 000 m)	500 125												
Dielectric withstanding voltage in VRMS	at sea level (at 21 000 m)	1500 375												
RF testing voltage in VRMS	sea level (5 MHz)	1000												

MECHANICAL CHARACTERISTICS

TEST/CHARACTERISTICS	STANDARD REFERENCE	VALUES/REMARKS
Durability		500 matings
Force to engage and disengage	axial torque	13.6 N max 28.6 Ncm
Coupling nut retention force		445 N
Cable retention force	cable 2/50, 2.6/50 cable 5/50, 10 + 11/50 cable .141"	227 N
Center contact retention force		27.2 N

ENVIRONMENTAL CHARACTERISTICS

TEST/CHARACTERISTICS	STANDARD REFERENCE	VALUES/REMARKS
Temperature range	flexible cables semi-rigid cables	MIL - 65°C + 165°C - 65°C + 105°C
Thermo cycling test		MIL STD 202, method 107, condition B
Thermal shock		MIL STD 202, method 107, condition B
Hight temperature endurance		MIL STD 202, method 108
Corrosion salt spray		MIL STD 202, method 101, condition B
Vibration		MIL STD 202, method 204, condition B
Shock		MIL STD 202, method 213, condition G
Moisture resistance		MIL STD 202, method 106
Hermetic test		MIL STD 202, method 112, condition C vacuum 10 ⁻⁶ Hgmm (Torr) leakage rate < 10 ⁻⁶ atm/cm ³ /s
Barometric pressure		Pressure test : 3.5 bars ; duration : 2 mn ; temperature : 15°C to 25°C

BNC 50 Ω

CHARACTERISTICS

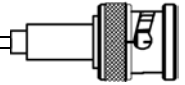

TEST/CHARACTERISTICS	STANDARD REFERENCE	VALUES/REMARKS
----------------------	--------------------	----------------

MATERIALS

Bodies		Brass
Center contact	male female	Brass Bronze or heat treated beryllium following QQ-C-530
Nut		Brass
Insulator		PTFE
Gasket		Silicon rubber

PLATINGS

Bodies		Nickel
Center contacts		Gold

POWER RATING

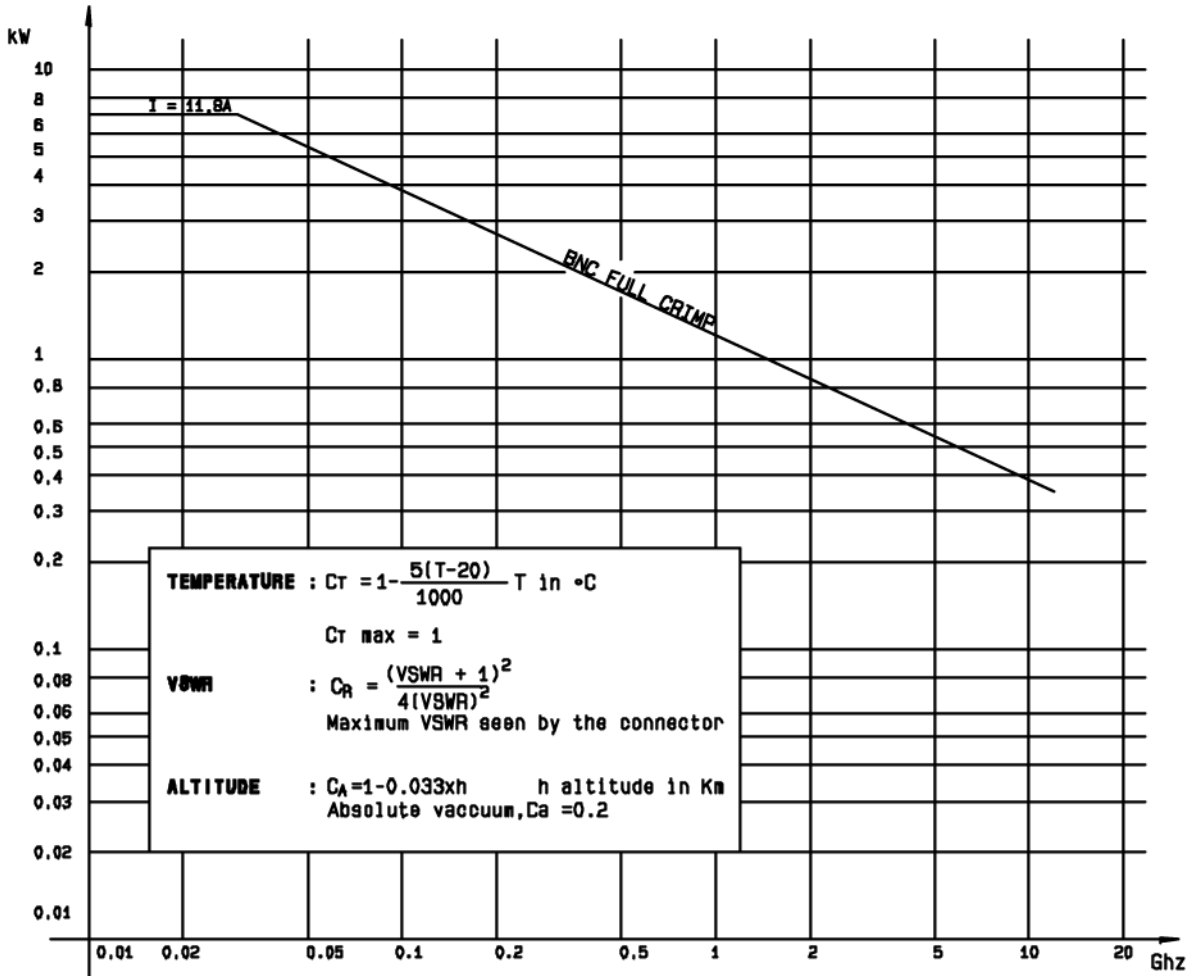

Standard packaging = 100 pieces. For unit packaging add «W» after the P/N

All dimensions are given in mm.

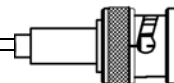

COMMERCIAL VERSION R141 XXX 161

TEST/CHARACTERISTICS	VALUES/REMARKS
----------------------	----------------

ELECTRICAL CHARACTERISTICS

Impedance	50 Ω
Operating frequency	DC to 1.5 GHz
V.S.W.R. typical (1.5 GHz)	
• <i>Straight models</i>	
∅ 2.6	1.21
∅ 5	1.14
∅ 6	1.05
• <i>Right angle models</i>	
∅ 5 & ∅ 6	1.17
Testing voltage (V.R.M.S)	1500
Operating voltage (V R.M.S)	500
Insulation resistance (MΩ)	5000
Contact resistance (mΩ)	10

MECHANICAL CHARACTERISTICS

Durability	100 mating
------------	------------

ENVIRONMENTAL CHARACTERISTICS

Temperature range	-35°C + 70°C
-------------------	--------------

MATERIALS

Male and female bodies	Brass
Coupling nut (straight knurl)	Die cast zinc
Outer contact	Brass
Insulators	Polypropylene
Male and female center contacts	Brass

PLATINGS

Bodies	Nickel
Center contact	Gold

STRAIGHT PLUGS CLAMP TYPE FOR FLEXIBLE CABLES

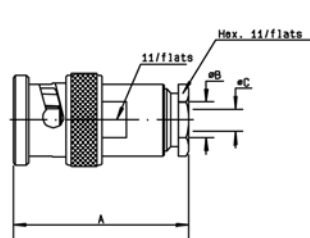

Fig. 1

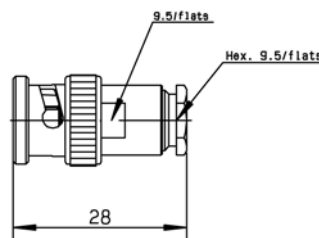

Fig. 2

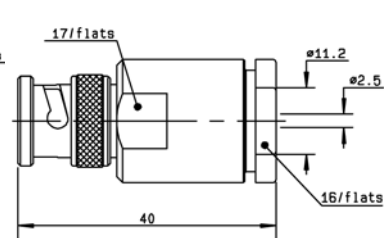

Fig. 3

Cable group	Part number	Fig.	Dimensions (mm)			Captive center contact	Assembly instructions	Note
			A	B	C			
2/50/S+D	R141 003 000	1	27	2.2	0.6	yes	M02	
2.6/50/S+D	R141 004 000			3.1				
5/50/S+D	R141 007 161	2				no	M03	Commercial version
	R141 009 000	1	28	5.6	1.2	no	M01	
	R141 010 000				1.05	yes		
10+11/50/S+D	R141 018 000	3						
.141"	R141 052 000	1	29	3.65	1.2	no	M09	Semi-rigid cable

STRAIGHT PLUGS FULL CRIMP TYPE FOR FLEXIBLE CABLES

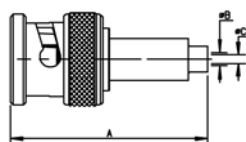

Fig. 1

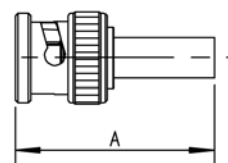

Fig. 2

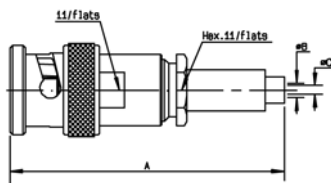

Fig. 3

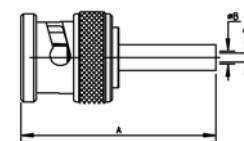
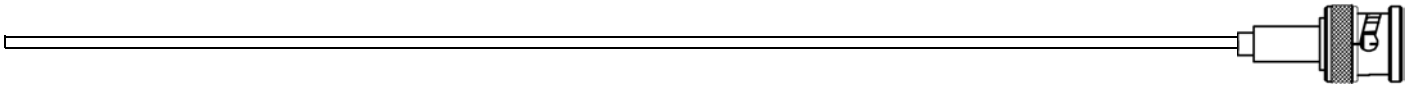

Fig. 4

Cable group	Part number	Fig.	Dimensions (mm)			Captive center contact	Assembly instructions	Note
			A	B	C			
2.6/50/S	R141 075 000	1	31	1.8	0.6		M05	Commercial version
	R141 075 161	2						
5/50/S	R141 072 000	3	28	3.1	1.05	yes	M08	Single piece body
	R141 082 000	4						
	R141 082 161	2						
	R141 083 000	4						
5/50/D	R141 083 000	4	3	1.05			M06	Single piece body

For others types of cables (75Ω, 93Ω or BT cables), please see "additional connectors" on page 32-33.



RIGHT ANGLE PLUGS CLAMP TYPE FOR FLEXIBLE CABLES

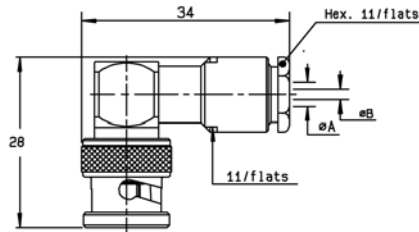

Fig. 1

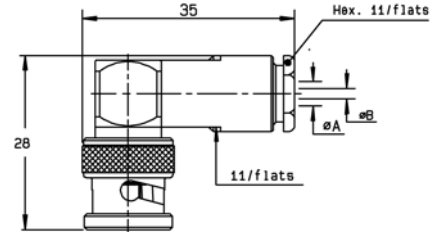

Fig. 2

Cable group	Part number	Fig.	Dimensions (mm)		Captive center contact	Assembly instructions	Note
			A	B			
2.6/50/S+D	R141 154 000	1	3.1	0.6	yes	M02	
5/50/S+D	R141 156 000	2	5.6	1.05		M01	Unit packaging

RIGHT ANGLE PLUGS FULL CRIMP TYPE FOR FLEXIBLE CABLES

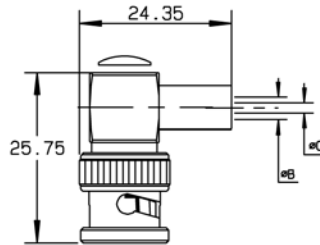

Fig. 1

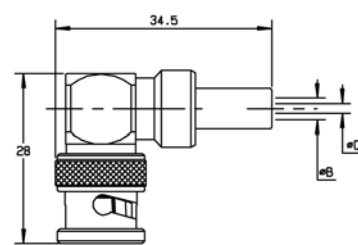
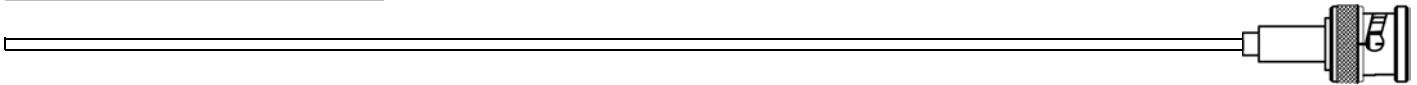

Fig. 2

Cable group	Part number	Fig.	Dimensions (mm)		Captive center contact	Assembly instructions	Note
			B	C			
2.6/50/S	R141 181 161	1	3.25	1.7	yes	M10	Commercial version
5/50/D	R141 182 000	2	5.5	1.05		M06	Single piece body
5/50/S	R141 182 161	1		3.15		M10	Commercial version
5/50/D	R141 183 000	2	5.8	1.05		M06	Single piece body

For others types of cables (75Ω, 93Ω or BT cables), please see "additional connectors" on page 32-33.



STRAIGHT JACKS CLAMP TYPE FOR FLEXIBLE CABLES

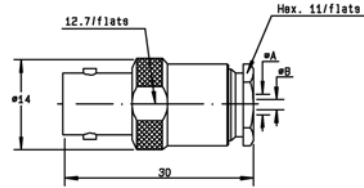

Cable group	Part number	Dimensions (mm)		Captive center contact	Assembly instructions
		A	B		
5/50/S+D	R141 207 000	5.6	1.05	no	M01
	R141 208 000			yes	

STRAIGHT JACKS FULL CRIMP TYPE FOR FLEXIBLE CABLES

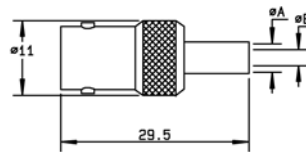

Cable group	Part number	Dimensions (mm)		Captive center contact	Assembly instructions	Note
		A	B			
2.6/50/S	R141 217 000		0.57		M05	
5/50/S	R141 237 000	5.5	1.05	yes	M06	Single piece body
	R141 237 161					Commercial version
5/50/D	R141 220 000					Single piece body

For others types of cables (75Ω, 93Ω or BT cables), please see "additional connectors" on page 32-33.

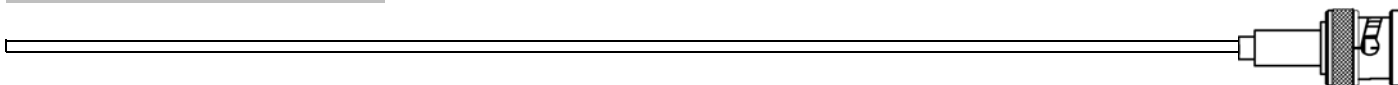

STRAIGHT SQUARE FLANGE JACKS CLAMP TYPE FOR FLEXIBLE CABLES

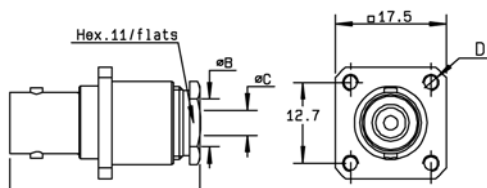

Fig. 1

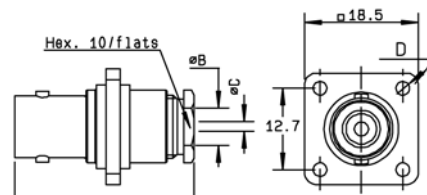

Fig. 2

Cable group	Part number	Fig.	Dimensions (mm)				Captive center contact	Assembly instructions	Panel drilling	Note
			A	B	C	D				
2/50/S+D	R141 253 000	1	29.5	2.2	0.6	3-56-UNF-2B	yes	M02	P01	
2.6/50/S+D	R141 254 000			3.1						
	R141 278 000			3						
5/50/S+D	R141 258 000	1	30	5.6	1.05	3-56-UNF-2B	no	M01	P01	Unit packaging
	R141 259 000*									2.6
		R141 256 000	2							

STRAIGHT SQUARE FLANGE JACKS FULL CRIMP TYPE FOR FLEXIBLE CABLES

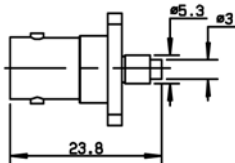
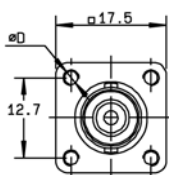

Fig. 1

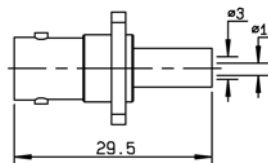

Fig. 2

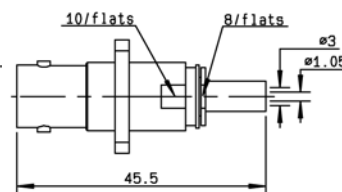
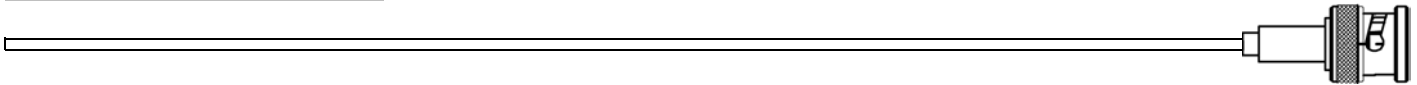

Fig. 3

Cable group	Part number	Fig.	Dimension D (mm)	Captive center contact	Assembly instructions	Panel drilling	Note
2.6/50/S	R141 290 200*	1	M3 x 0.5	yes	M11	P04	Reverse crimping - unit packaging
5/50/S	R141 292 000	2	3 x 56 UNEF 2B		M06	P23	Single piece body
5/50/D	R141 297 000	3	M2.5 x 0.45		M07		

For others types of cables (75Ω, 93Ω or BT cables), please see "additional connectors" on page 32-33.

• Upon request



STRAIGHT BULKHEAD JACKS CLAMP TYPE

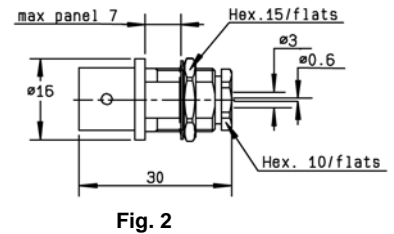
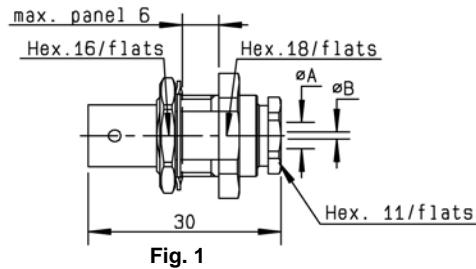

Cable	Part number	Fig.	Dimensions (mm)		Captive center contact	Assembly instructions	Panel drilling	Note
			A	B				
2/50/S	R141 323 000	1	2.2	0.6	yes	M02	P17	Panel sealed
2.6/50/S	R141 304 000	2						
	R141 324 000	1	3.1	0.6	no	M01		
5/50/S+D	R141 327 000	1	5.6	1.05				

STRAIGHT BULKHEAD JACKS CRIMP TYPE FOR FLEXIBLE CABLES

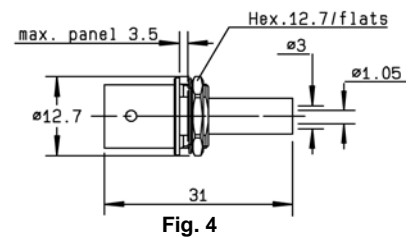
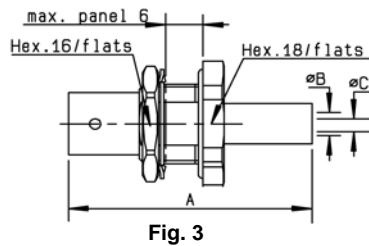
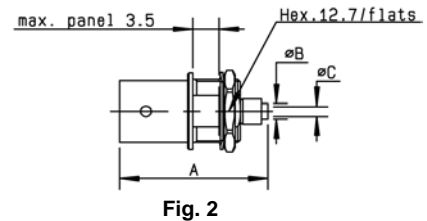
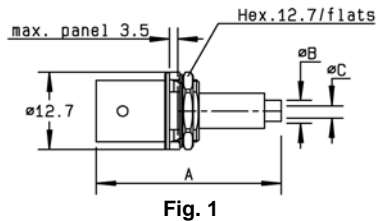

Cable group	Part number	Fig.	Dimensions (mm)			Captive center contact	Assembly instructions	Panel drilling	Note
			A	B	C				
2/50/D	R141 301 000*	1	33.35	1.1	0.6	yes	M05	P18	Unit packaging
	R141 306 000		34	1.7					Reverse crimping/ commercial version
2.6/50/S	R141 306 503	2	26	2.95			M11	P17 or P20	Panel sealed
	R141 331 500	3	38.5	1.7			M05		
5/50/S	R141 308 000	4	31	3	1.05		M06	P18	Single piece body
	R141 332 161	3	35.5	3.1	1.05			P17 or P20	Panel sealed/ commercial version
	R141 332 500					Panel sealed / single piece body			

For others types of cables (75Ω, 93Ω or BT cables), please see "additional connectors" on page 32-33..

• Upon request

FLANGE RECEPTACLES

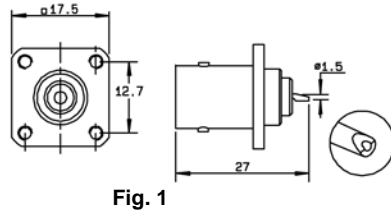

Fig. 1

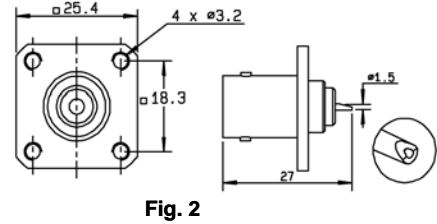

Fig. 2

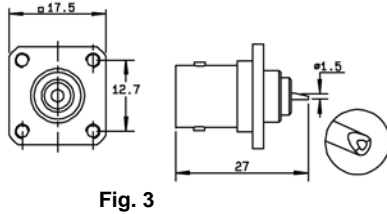

Fig. 3

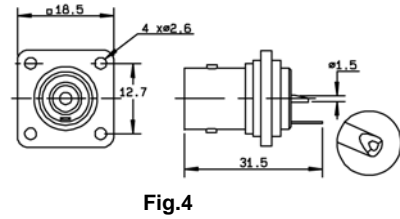

Fig. 4

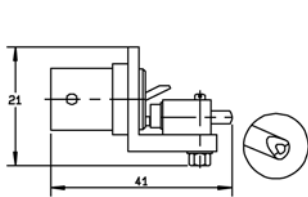

Fig. 5

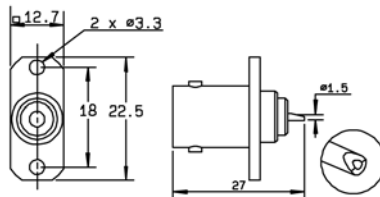

Fig. 6

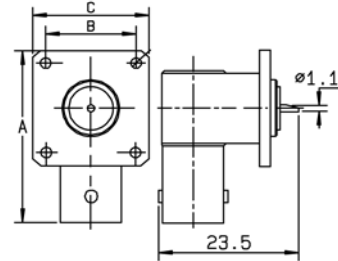
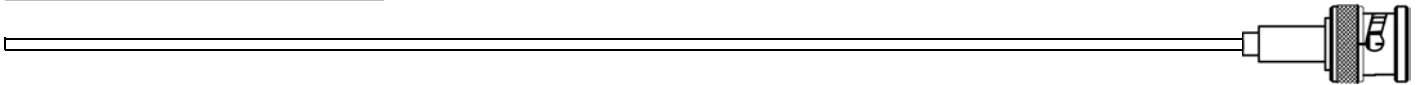

Fig. 7

Part number	Fig.	Dimensions (mm)			Captive center contact	Panel drilling	Flange holes	Note			
		A	B	C							
R141 403 000	1				yes	P08	4 x M2.5	Flange dimensions of N series (1) / unit packaging			
R141 403 500*	2					P10					
R141 404 000	3					P07	4 x M2.5				
R141 406 000	1					P08	4 x 2.6				
R141 407 000	3					P07					
R141 410 000	4					P02	Insulated flange / solder tag				
R141 439 000	5					P13	4 x M2.5	Auxiliary contact			
R141 453 000	6					P24		2 hole flange			
R141 653 000	7					27.6	13.5	19	P05	4 x 3.3	Right angle receptacle
R141 654 000						26.9	12.7	17.5	P06	4 x 2.6	Right angle receptacle

(1) Look in the catalog for N series

• Upon request



STRAIGHT BULKHEAD RECEPTACLES WITH SOLDER POT

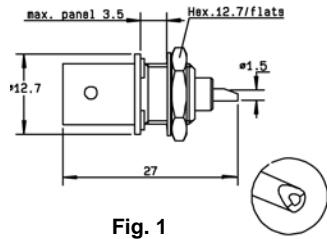

Fig. 1

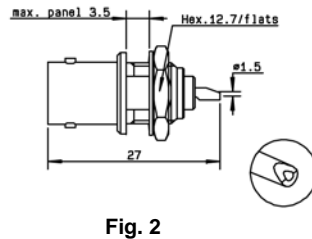

Fig. 2

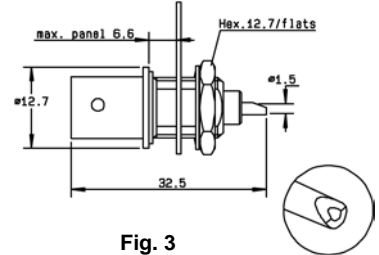

Fig. 3

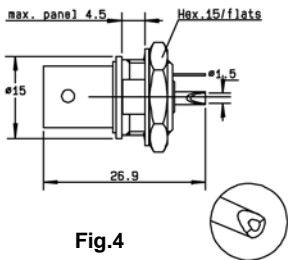

Fig. 4

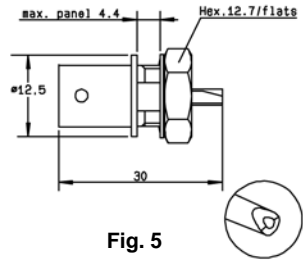

Fig. 5

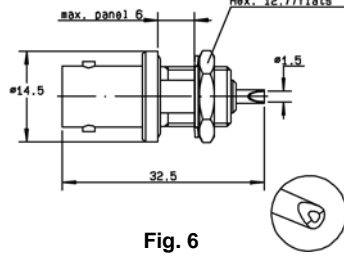

Fig. 6

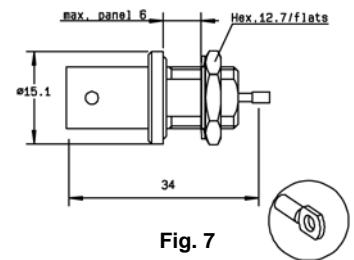
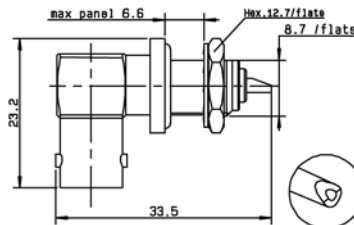

Fig. 7

Part number	Fig.	Captive center contact	Panel drilling	Note
R141 554 000	1	yes	P16	
R141 554 161			P16	Commercial version
R141 557 000			P18	Solder tag
R141 559 000	Silver plated center contact / commercial version			
R141 563 161	2			
R141 572 000	4			
R141 574 000	5			
R141 574 161			P17	Insulated receptacle + solder tag
R141 603 000	6			
R141 605 000			P18	Commercial version
R141 603 000		P19	Fully sealed / Q200-5 insulator	
R141 625 000	7			
			P18	Fully sealed
			P18	Hermetically sealed

RIGHT ANGLE BULKHEAD RECEPTACLE WITH SOLDER POT



Part number	Captive center contact	Panel drilling
R141 680 000	yes	P18

SCREW ON RECEPTACLE

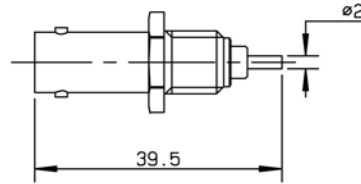

Part number	Captive center contact	Panel drilling	Note
R141 561 161	yes	P22	Commercial version / packaging 500 pieces

PRESS MOUNT RECEPTACLE

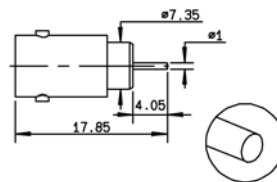
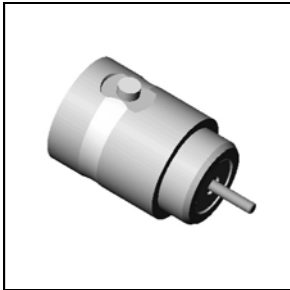

Part number	Captive center contact	Panel drilling
R141 500 200*	yes	P15

MALE RECEPTACLES

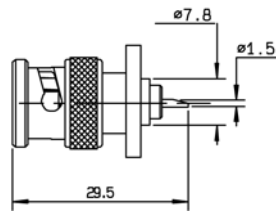
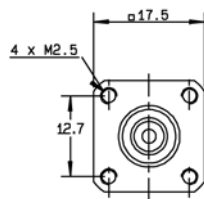

Fig. 1

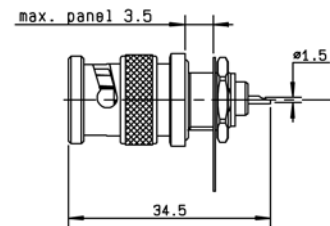
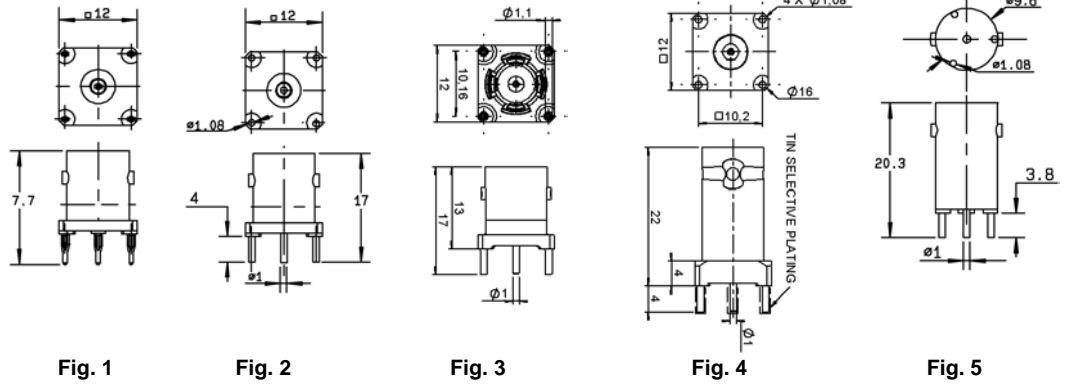

Fig. 2

Part number	Fig.	Captive center contact	Panel drilling	Note
R141 440 000	1	yes	P03	Panel sealed / solder tag
R141 580 000	2		P18	

* Upon request

STRAIGHT PCB FEMALE RECEPTACLES



Part number	Fig.	Captive center contact	Panel drilling	Assembly instructions	Note
R141 416 000*	1	yes	P12	M13	Press-fit pins
R141 426 000	2				
R141 426 161	3				Die casted body / commercial version
R141 426 165	4				Tin lead legs / commercial version
R141 508 200*	5			P21	

RIGHT ANGLE PCB FEMALE RECEPTACLES

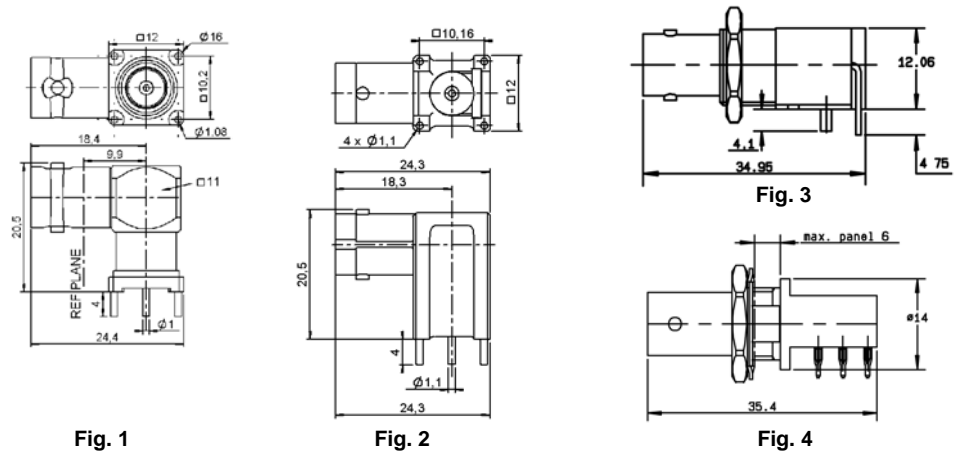

Part number	Fig.	Captive center contact	Panel drilling	Assembly instructions	Finish	Note
R141 665 000	1	yes	P09		Nickel	Tin lead legs
R141 665 030*	2					
R141 665 161					Rear mount + washer / unit packaging	
R141 676 423*	3		P14 and P17		Gold	Rear mount + 2 insulated washer / unit packaging
R141 676 433*						
R141 684 130	4		P11 and P20	M12	Nickel	Packaging 10 / press-fit pins

• Upon request

IN SERIES ADAPTERS

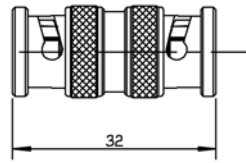

Fig. 1

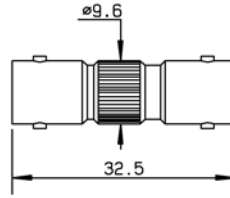

Fig. 2

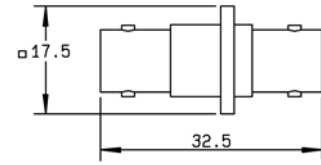

Fig. 3

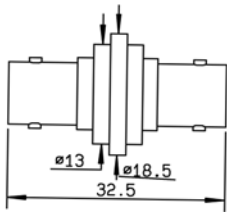

Fig. 4

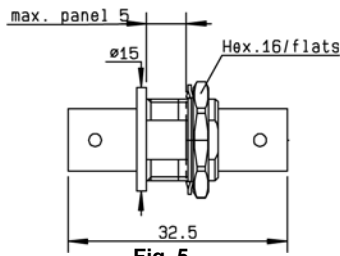

Fig. 5

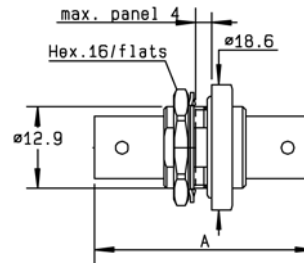

Fig. 6

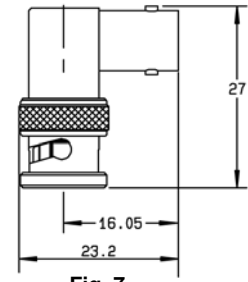
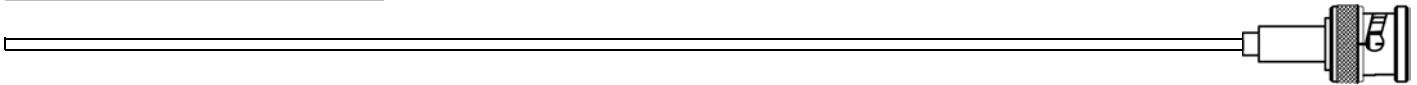

Fig. 7

Part number	Fig.	Captive center contact	Dimension A (mm)	Flange holes	Panel drilling	Note				
R141 703 000	1	yes				Male - male				
R141 704 000	2					Female - female				
R141 710 000	3					4 x M2,5	P13	Female - female square flange		
R141 717 000	4					4 x 2,6	P02	Female - female square insulated flange		
R141 720 000	5							P17	Female - female bulkhead	
R141 720 161									Female - female bulkhead / commercial version	
R141 723 000									Female - female insulated bulkhead	
R141 723 161									Female - female insulated bulkhead / commercial version	
R141 730 000	6						35.7		P17	Female - female panel sealed bulkhead
R141 753 000										Female - female hermetically sealed bulkhead
R141 770 000	7					Male - female right angle				



CROSS AND TEE IN SERIES ADAPTERS

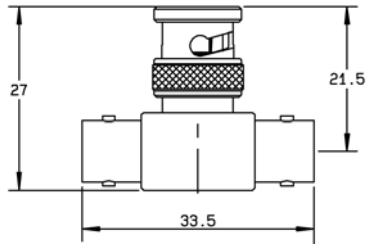

Fig. 1

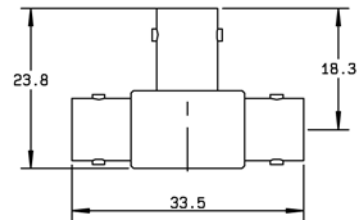

Fig. 2

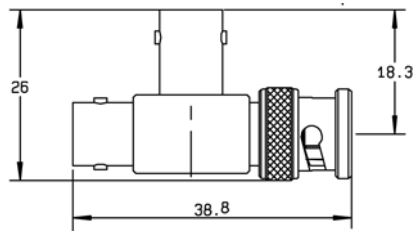

Fig. 3

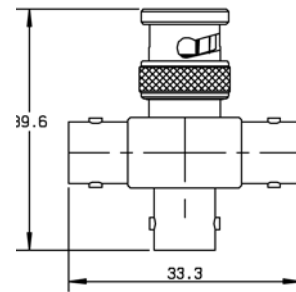
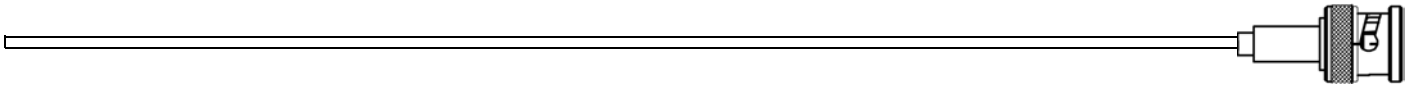

Fig. 4

Part number	Fig.	Captive center contact	Note
R141 780 000	1	yes	Male / female-female tee
R141 782 000	2		Female / female-female tee
R141 789 000	3		Female / female-male tee
R141 799 000*	4		Male / female-female-female cross / unit packaging

• Upon request



MALE AND FEMALE CAPS

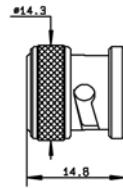

Fig. 1

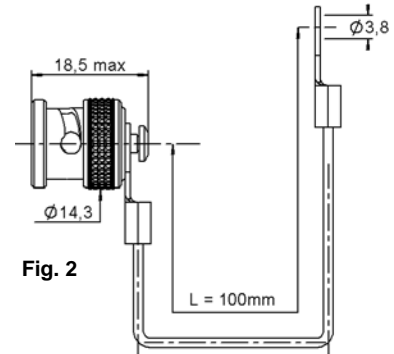

Fig. 2

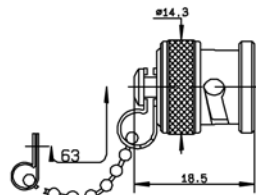

Fig. 3

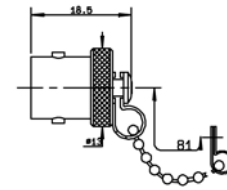
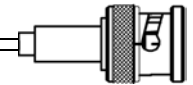

Fig. 4

Part number	Fig.	Note
R141 802 000	1	Male
R141 805 000	2	Male with cord
R141 812 000	3	Male with chain
R141 842 000	4	Female with chain
R141 862 000	3	Male short circuit / with chain



TEST/CHARACTERISTICS	STANDARD REFERENCE	VALUES/REMARKS
----------------------	--------------------	----------------

ELECTRICAL CHARACTERISTICS

Impedance		75 Ω
Frequency range		DC-1 GHz
V.S.W.R. max • <i>Straight models cable group</i> : 2.6/75, 5/75, 6/75, 8/75, 10 + 11/75 • <i>Right angle models</i> : 2.6/75, 6/75		1.30 1.35
Insertion loss	straight connector right-angle connector	0.2 dB max at 1 GHz 0.3 dB max at 1 GHz
RF Leakage		- 55 dB min from 2 to 3 GHz
Insulation resistance		5000 MΩ min
Contact resistance	center contact outer contact	1.5 mΩ 0.2 mΩ
Working voltage in VRMS	at sea level (at 21 000m)	500 125
Dielectric withstanding voltage in VRMS	at sea level (at 21 000m)	1500 375
RF testing voltage in VRMS	sea level (5 MHz)	1000

MECHANICAL CHARACTERISTICS

Durability		500 matings
Force to engage and disengage	axial Torque	13.6 N max 28.6 Ncm
Coupling nut retention force		445 N
Cable retention force	cable 2.6/75, 5/75, 6/75, 8/75, 10 + 11/75	340 N
Center contact retention force		27 N

ENVIRONMENTAL CHARACTERISTICS

Temperature range	flexible cables	- 65°C + 165°C
Thermo cycling test		MIL STD 202, method 107, condition B
Hight temperature endurance		MIL STD 202, method 108
Corrosion salt spray		MIL STD 202, method 101, condition B
Vibration		MIL STD 202, method 204, condition B
Shock		MIL STD 202, method 213, condition G
Moisture resistance		MIL STD 202, method 106
Hermetic test		MIL STD 202, method 112, condition C vacuum 10 ⁻⁶ Hgmm (Torr) leakage rate <10 ⁻⁶ atm/cm ³ /s
Barometric pressure		Pressure test : 3.5 bars; duration : 2 mn; temperature : 15° C to 25°C

MATERIALS

Bodies		Brass
Center contact	male female	Brass Bronze or heat treated beryllium following QQ-C-530
Nut		Brass
Insulator		PTFE
Gasket		Silicon rubber

Standard packaging = 100 pieces. For unit packaging add «W» after the P/N

All dimensions are given in mm

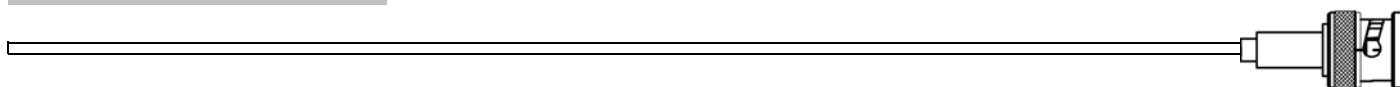

TEST/CHARACTERISTICS	VALUES/REMARKS
----------------------	----------------

PLATINGS

Bodies	Nickel
Center contacts	Gold

COMMERCIAL VERSION R142 XXX 161

TEST/CHARACTERISTICS	VALUES/REMARKS
----------------------	----------------

ELECTRICAL CHARACTERISTICS

Impedance	50 Ω
Operating frequency	DC to 1.5 GHz
V.S.W.R. typical (1.5 GHz)	
• <i>Straight models</i>	
∅ 2.6	1.21
∅ 5	1.14
∅ 6	1.05
• <i>Right angle models</i>	
∅ 5 & ∅ 6	1.17
Testing voltage (V.R.M.S)	1500
Operating voltage (V R.M.S)	500
Insulation resistance (MΩ)	5000
Contact resistance (mΩ)	10

MECHANICAL CHARACTERISTICS

Durability	100 mating
------------	------------

ENVIRONMENTAL CHARACTERISTICS

Temperature range	-35°C + 70°C
-------------------	--------------

MATERIALS

Male and female bodies	Brass
Coupling nut (straight knurl)	Die cast zinc
Outer contact	Brass
Insulators	Polypropylene
Male and female center contacts	Brass

PLATINGS

Bodies	Nickel
Center contact	Gold

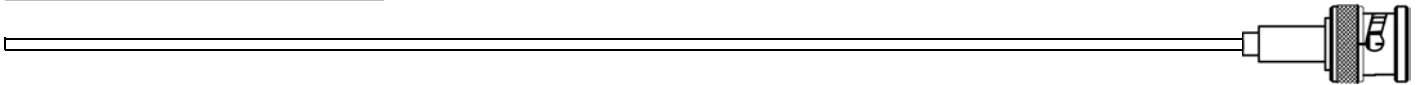

STRAIGHT PLUGS CLAMP TYPE FOR FLEXIBLE CABLES

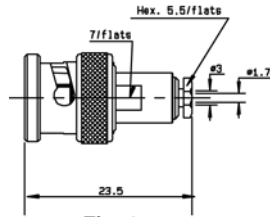

Fig. 1

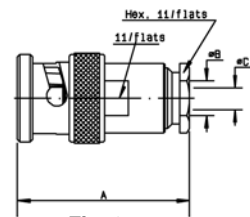

Fig. 2

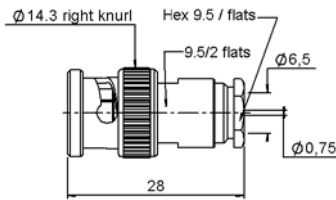

Fig. 3

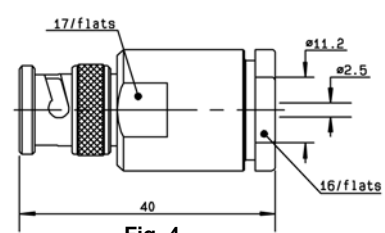

Fig. 4

Cable group	Part number	Fig.	Dimensions (mm)			Captive center contact	Assembly instructions	Note
			A	B	C			
2.6/75/S	R142 004 000	1				yes	M04	
6/75/S	R142 016 000	2	28	6.6	0.75		M01	Unit packaging
	R142 016 161	3				M03	Commercial version Unit packaging	
8/75/S+D	R142 017 000	2	45.5	9.1	1.5	yes		
10+11/75/S+D	R142 018 000	4					M01	

STRAIGHT PLUGS FULL CRIMP TYPE FOR FLEXIBLE CABLES

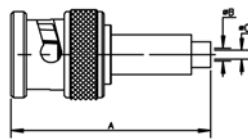

Fig. 1

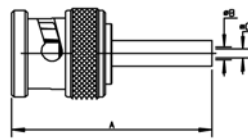

Fig. 2

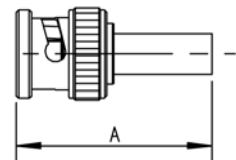
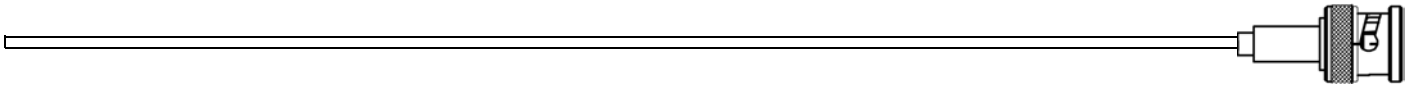

Fig. 3

Cable group	Part number	Fig.	Dimensions (mm)			Captive center contact	Assembly instructions	Note
			A	B	C			
2.6/75/S	R142 076 000	1	31	1.8	0.4	yes	M05	
	R142 076 161	3						
3.8/93/S	R142 078 161		30	3.85	0.6		M14	
5/75/D	R142 083 000	2	27.3	5.5	0.75		M06	
6/75/S	R142 085 000		28	6.6				Single piece body
	R142 085 161	3		3.9				Commercial version
10/75/S	R142 095 000	2		11.05	1.35		Single piece body	

For others types of cables (75Ω, 93Ω or BT cables), please see "additional connectors" on page 32-33.



RIGHT ANGLE PLUGS CLAMP TYPE FOR FLEXIBLE CABLES

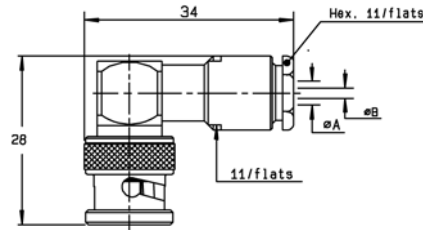

Fig. 1

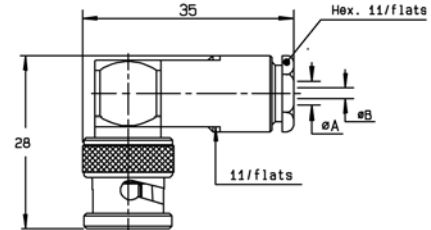

Fig. 2

Cable group	Part number	Fig.	Dimensions (mm)		Captive center contact	Assembly instructions
			A	B		
2.6/75/S	R142 154 000	1	3.1	0.6	yes	M02
6/75/S	R142 157 000	2	6.6	0.75		M01

RIGHT ANGLE PLUGS FULL CRIMP TYPE FOR FLEXIBLE CABLES

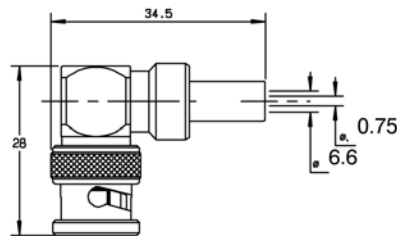

Fig. 1

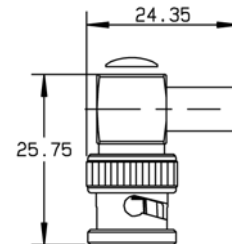
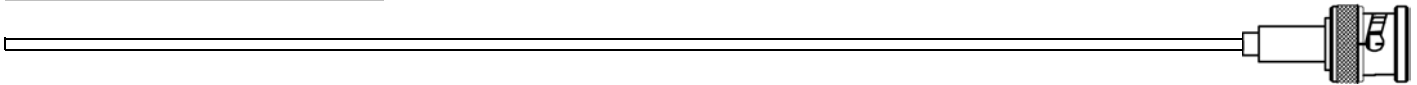

Fig. 2

Cable group	Part number	Fig.	Captive center contact	Assembly instructions	Note
6/75/S	R142 184 000	1	yes	M06	Commercial version
	R142 184 161	2		M10	

For others types of cables (75Ω, 93Ω or BT cables), please see "additional connectors" on page 32-33.



STRAIGHT JACKS FULL CRIMP TYPE FOR FLEXIBLE CABLES

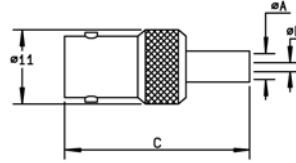

Cable group	Part number	Dimensions (mm)			Captive center contact	Assembly instructions	Note
		A	B	C			
2.6/75/S	R142 217 000	1.75	0.4	32.5	yes	M05	
6/75/S	R142 242 000	6.6	0.75	29.5		M06	Single piece body
	R142 242 161			29			Single piece body / commercial version

STRAIGHT SQUARE FLANGE JACKS CLAMP TYPE FOR FLEXIBLE CABLES

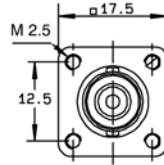
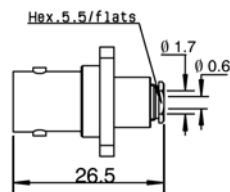

Fig. 1

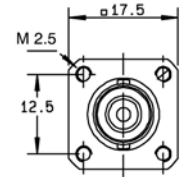
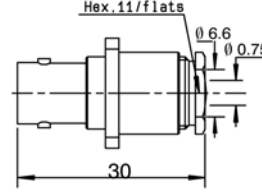
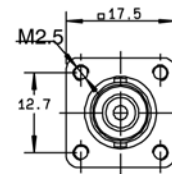
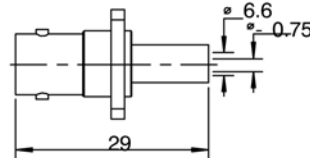

Fig. 2

Cable group	Part number	Fig.	Captive center contact	Assembly instructions	Panel drilling	Note
2.6/75/S	R142 202 000	1	yes	M04	P01	Unit packaging
6/75/S	R142 268 000	2		M01		

STRAIGHT SQUARE FLANGE JACKS FULL CRIMP TYPE FOR FLEXIBLE CABLES



Cable group	Part number	Captive center contact	Assembly instructions	Panel drilling	Note
6/75/S	R142 295 000	yes	M06	P01	Single piece body / unit packaging
	R142 295 161				Single piece body / commercial version

For others types of cables (75Ω, 93Ω or BT cables), please see "additional connectors" on page 32-33.

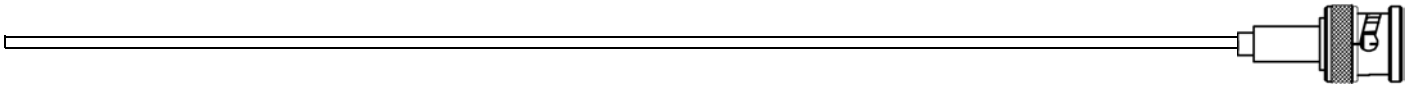

STRAIGHT BULKHEAD JACKS CLAMP TYPE FOR FLEXIBLE CABLES

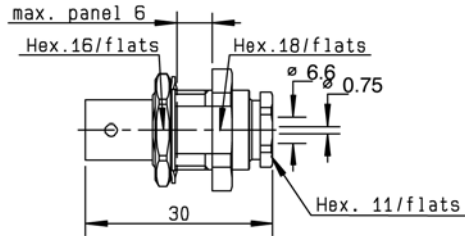

Cable group	Part number	Captive center contact	Assembly instructions	Panel drilling	Note
6/75/S	R142 329 000	yes	M01	P17	Panel sealed

STRAIGHT BULKHEAD JACKS CRIMP TYPE FOR FLEXIBLE CABLES

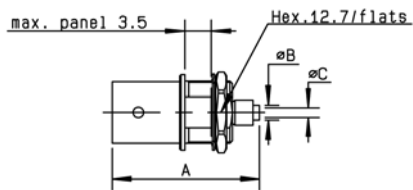

Fig. 1

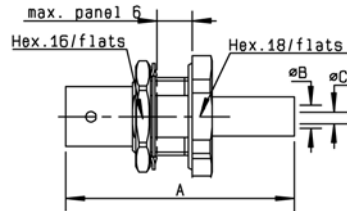
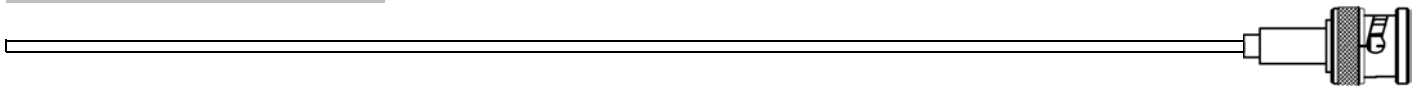
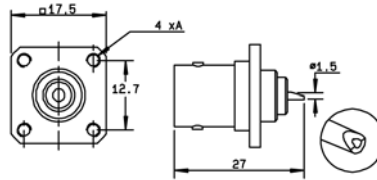

Fig. 2

Cable group	Part number	Fig.	Dimensions (mm)			Captive center contact	Assembly instructions	Panel drilling	Note
			A	B	C				
2.6/75/S	R142 306 500	1	26	2.95	0.4	yes	M11	P18	Reverse crimping - commercial version
	R142 306 503				0.6				Reverse crimping
	R142 306 520*				0.6				Reverse crimping
	R142 331 011*	2	38	1.75	0.4		M05	P17 or P20	Panel sealed / silver plated
6/75/S	R142 334 161	35	6.6	0.75	M06	Commercial version			



STRAIGHT SQUARE FLANGE RECEPTACLES WITH SOLDER POT



Part number	Captive center contact	Panel drilling	Flange holes A	Note
R142 407 000	yes	P07	4 x 2.6	
R142 412 000			4 x M2.5	Unit packaging

STRAIGHT BULKHEAD RECEPTACLES WITH SOLDER POT

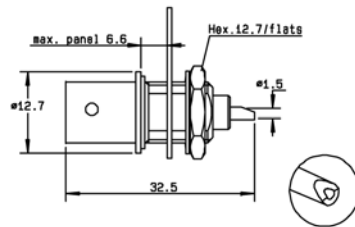

Fig. 1

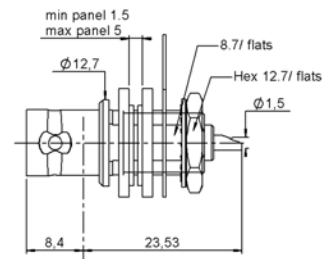
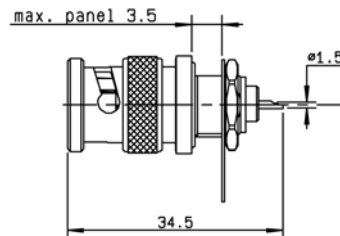

Fig. 2

Part number	Fig.	Captive center contact	Panel drilling	Note
R142 562 000	1	yes	P18	Unit packaging
R142 562 290*	2			With 2 insulated washers + solder tag / Unit packaging

BULKHEAD MALE RECEPTACLE WITH SOLDER POT



Part number	Captive center contact	Panel drilling	Note
R142 580 000	yes	P18	Panel sealed + solder tag / Unit packaging

• Upon request

STRAIGHT PCB FEMALE RECEPTACLES

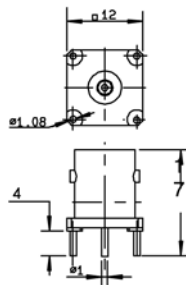

Fig. 1

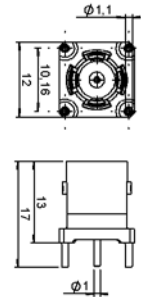

Fig. 2

Part number	Fig.	Captive center contact	Panel drilling	Note
R142 426 030*	1	yes	P09	
R142 426 161	2			Commercial version

IN SERIES ADAPTERS

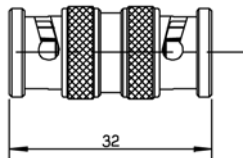

Fig. 1

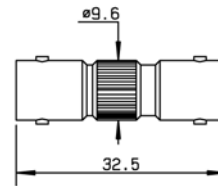

Fig. 2

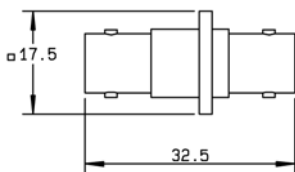

Fig. 3

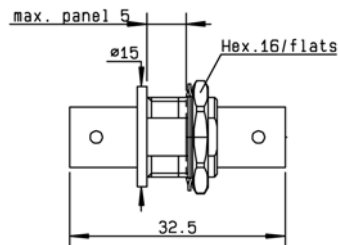

Fig. 4

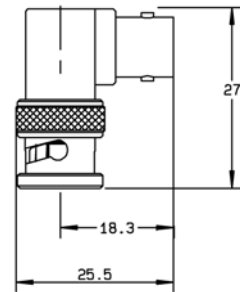
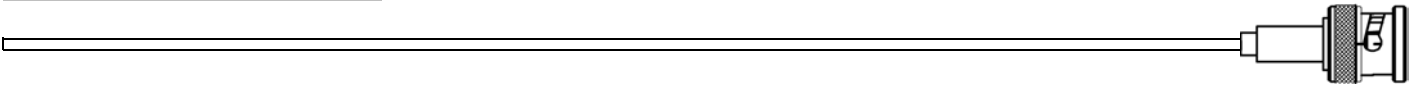

Fig. 5

Part number	Fig.	Captive center contact	Panel drilling	Note
R142 703 000	1	yes		Male - male
R142 704 000	2			Female - female
R142 710 000	3		P01	Female - female square flange
R142 720 000	4		P17	Female - female bulkhead
R142 720 161			P17	Female - female bulkhead / commercial version
R142 723 000			P17 or P20	Female - female insulated bulkhead
R142 770 000	5			

• Upon request



TEE IN SERIES ADAPTERS

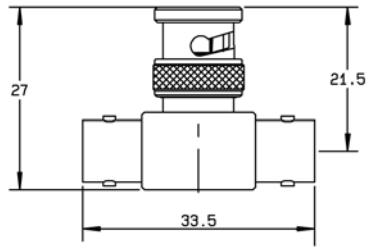

Fig. 1

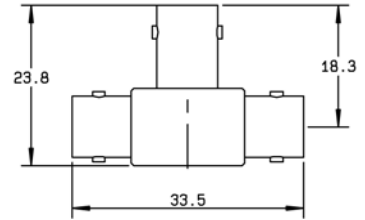

Fig. 2

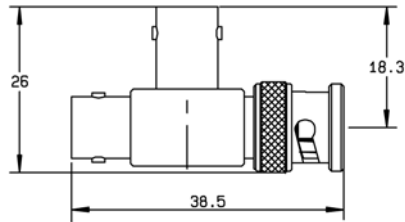
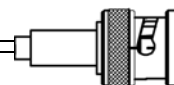

Fig. 3

Part number	Fig.	Captive center contact	Note
R142 780 000	1	yes	Male / female-female tee
R142 782 000	2		Female / female-female tee
R142 789 000	3		Female / female-male tee



For more information regarding these connectors, please consult us.

R141
↓
BNC 50 Ω

R142
↓
BNC 75 Ω

CONNECTORS WITH FLAT GASKET

P/N	Description	Captive center contact
R141 007 000	Straight plug clamp type for 5/50/S+D cable	no
R141 011 000	Straight plug clamp type for 6/75/S cable	
R141 015 000	Straight plug clamp type for 6/75/S cable	
R141 154 000	Right angle plug clamp type for 2.6/50/S+D cable	yes
R141 206 000	Straight jack clamp type for 5/50/S+D cable	no
R141 209 000	Straight jack clamp type for 6/75/S cable	
R141 256 000	Straight square flange jack clamp type for 5/50/S+D cable	
R141 257 000	Straight square flange jack clamp type for 5/50/S cable	
R141 261 000	Straight square flange jack clamp type for 6/75/S cable	
R141 264 000	Straight insulated square flange jack clamp type for 6/75/S cable	
R142 017 000	Straight plug clamp type for 8/75/S+D cable (unit packaging)	

50 Ω CONNECTORS FOR 75 Ω or 93 Ω CABLE

75 Ω Cable

P/N	Description	Captive center contact
R141 004 000	Straight plug clamp type for 2.6/75/S cable	yes
R141 011 000	Straight plug clamp type for 6/75/S cable	no
R141 013 000	Straight plug clamp type for 6/75/S cable	
R141 014 000	Straight plug clamp type for 6/75/S cable	yes
R141 015 000	Straight plug clamp type for 6/75/S cable	no
R141 074 000	Straight plug clamp type for 6/75/S cable	yes
R141 082 280	Straight plug crimp type for PH18 cable (unit packaging)	
R141 154 000	Right angle plug clamp type for 2.6/75/D cable	no
R141 209 000	Straight jack clamp type for 6/75/S cable	
R141 210 000	Straight jack clamp type for 6/75/S cable	yes
R141 254 000	Straight square flange jack clamp type for 2.6/75/S cable	no
R141 261 000	Straight square flange jack clamp type for 6/75/S cable	
R141 264 000	Straight insulated square flange jack clamp type for 6/75/S cable	yes
R141 277 000	Straight insulated square flange jack clamp type for 2.6/75/S cable	
R141 278 000	Straight square flange jack clamp type for 2.6/75/S cable	yes
R141 329 000	Straight bulkhead jack clamp type for 6/75/S cable	
R141 334 161	Straight bulkhead jack crimp type for 6/75/S cable	
R141 334 500	Straight bulkhead jack crimp type for 6/75/S cable (unit packaging)	

93 Ω Cable

P/N	Description	Captive center contact
R141 013 000	Straight plug clamp type for 6/93/S cable	no
R141 014 000	Straight plug clamp type for 6/93/S cable	yes
R141 077 000	Straight plug crimp type for 3.8/93/S cable	

Standard packaging : 100 pieces

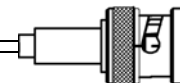

75 Ω CONNECTORS FOR 93 Ω CABLE

P/N	Description	Packaging
R142 016 000	Straight plug clamp type for 6/93/S cable	Unit
R142 085 000	Straight plug crimp type for 6/93/S cable	100 pieces

CONNECTORS FOR BT OR SPECIAL CABLES Look at BT43 catalog

P/N	Description	Packaging
R141 005 000	Straight plug clamp type dia 3,5/50, PPD cable	100 pieces
R141 015 000	Straight plug clamp type dia 6/75/S, 75PD cable	
R141 082 280	Straight plug crimp type for 6/75, PH 18 cable	Unit
R142 080 000	Straight plug crimp type for 3,8/75/T, ET 33542 cable	100 pieces
R142 081 100	Straight plug crimp type for 3,6/75/D, P46431 cable	100 pieces
R142 081 120	Straight plug crimp type for BT3002 / TZC 75024 cable	Unit
R142 081 130	Straight plug crimp type for BT3002 / TZC 75024 cable	100 pieces
R142 081 320	Straight plug crimp type for BT2001 cable	Unit
R142 081 330	Straight plug crimp type for BT2001 cable	100 pieces
R142 083 320	Straight plug crimp type for BT2002 cable	Unit
R142 083 330	Straight plug crimp type for BT2002 cable	100 pieces
R142 085 230	Straight plug crimp type for BICC T3304 cable	
R142 086 320	Straight plug crimp type for BT2003 cable	Unit
R142 086 340	Straight plug crimp type for BT2003 cable	100 pieces
R142 177 200	Right angle plug crimp type for BT3002 / TZC 75024 cable	
R142 177 200W	Right angle plug crimp type for BT3002 / TZC 75024 cable	Unit
R142 181 200	Right angle plug crimp type for BT2002 cable	100 pieces
R142 181 200W	Right angle plug crimp type for BT2002 cable	unit
R142 185 200	Right angle plug crimp type for BT2003 cable	100 pieces
R142 185 200W	Right angle plug crimp type for BT2003 cable	Unit
R142 325 100W	Straight bulkhead jack crimp type for BT3002 / TZC 75024 cable	100 pieces
R142 325 106	Straight bulkhead jack crimp type for BT3002 / TZC 75024 cable	

CONNECTORS FOR DIGITAL BROADCAST APPLICATIONS Special finish

Connectors developed for NOKIA 0.6/2.8 AF 75 Ω cable.

P/N	Description	Packaging	Outer contact finish	Body finish
R142 082 042	Straight plug crimp type for 5/75/S cable	100 pieces	Gold	BBR*
R142 082 042W	Straight plug crimp type for 5/75/S cable	unit		
R142 082 047	Straight plug crimp type for 5/75/S cable	100 pieces	BBR*	
R142 082 047W	Straight plug crimp type for 5/75/S cable	unit		
R142 720 023	Female female bulkhead adapter	100 pieces	-	Gold

* BBR : Bright Bronze RADIALL.

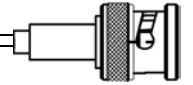

P01

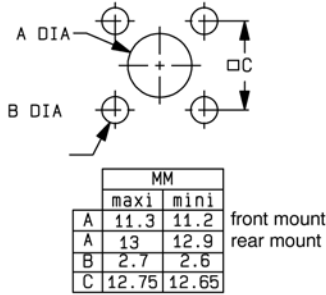

P02

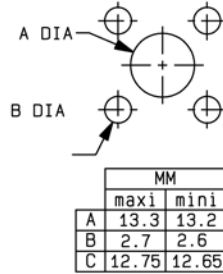

P03

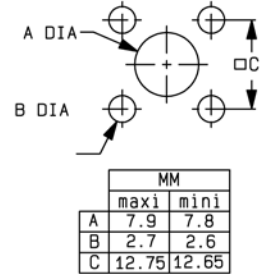

P04

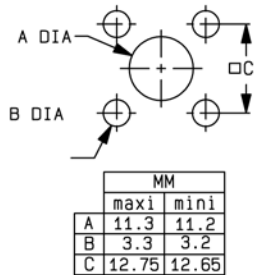

P05

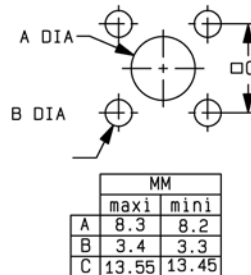

P06

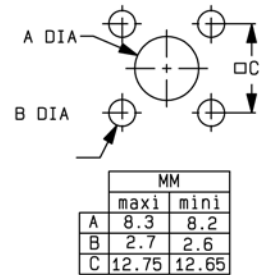

P07

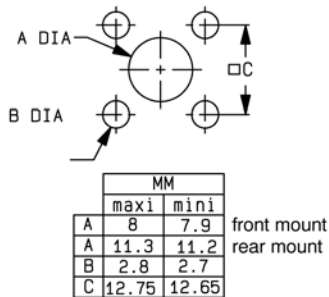

P08

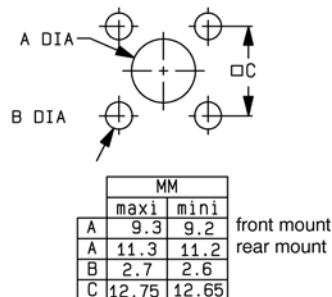

P09

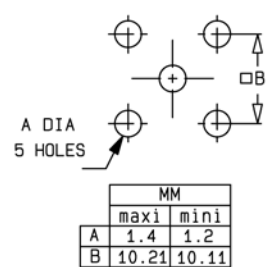

P10

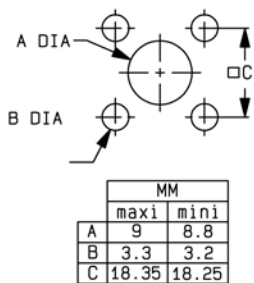

P11

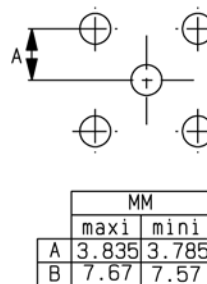

P12

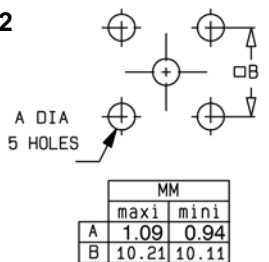

P13

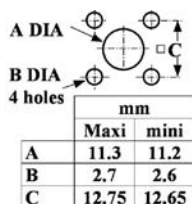

P14

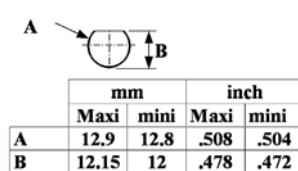

P15

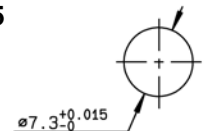

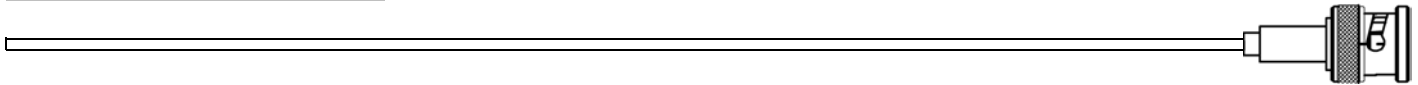

P16

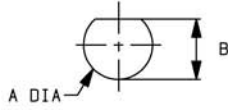

MM		
	maxi	mini
A	11.25	11.15
B	10.43	10.35

P17

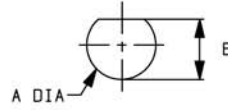

MM		
	maxi	mini
A	12.9	12.8
B	12.15	12.05

P18

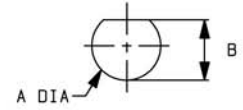

MM		
	maxi	mini
A	9.7	9.6
B	8.9	8.8

P19

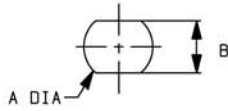

MM		
	maxi	mini
A	9.75	9.65
B	8.65	8.55

P20

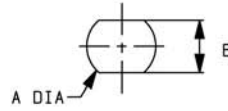

MM		
	maxi	mini
A	12.8	12.7
B	10.9	10.8

P21

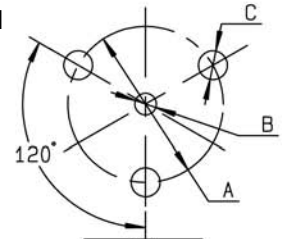

MM		
	maxi	mini
A	8.65	8.55
B	1.3	1.1
C	1.7	1.5

P22

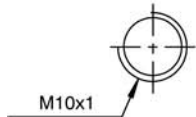

P23

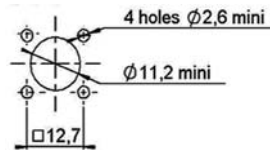

P24

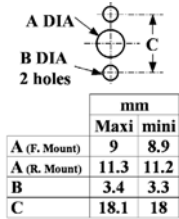

mm		
	Maxi	mini
A (F. Mount)	9	8.9
A (R. Mount)	11.3	11.2
B	3.4	3.3
C	18.1	18

M 01

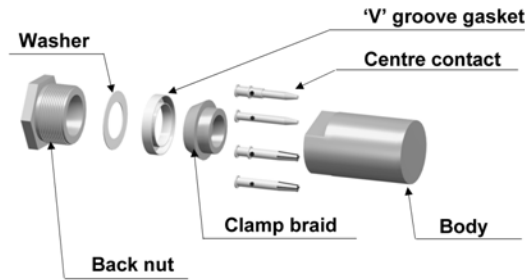

STRIPPING DIMENSIONS

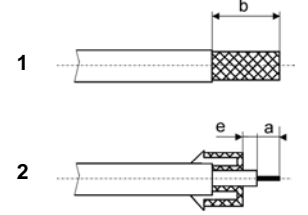

Part Number	Stripping length (mm)			Recommended coupling torque
	a	b	e	
R141 009 000 R141 010 000	4.5	8.5	2.5	450 N.cm
R141 013 000	5.5	6	0.5	
R141 156 000 R141 208 000 R141 258 000 R141 259 000 R141 327 000 R142 016 000 R142 157 000 R142 268 000 R142 329 000	2.5	7	3	
R141 018 000 R141 207 000 R142 018 000	3	9	1	

1 - Strip the cable as shown in sketch 1.

2 - Slide the back nut, the washer and the 'V' groove gasket onto the cable.
- Slide the clamp braid sleeve over the braid.

3 - Fold the braid back and trim off the extra braid.
- Trim dielectric back as shown in sketch 2.

4 - Slide the back nut over the cable assembly.
- Slide the centre contact onto the inner conductor.

5 - Solder the centre contact onto the inner conductor.

6 - Screw sub-assembly into the connector body with the adapted wrench.
- Recommended coupling torque (see table).

M 02

STRIPPING DIMENSIONS

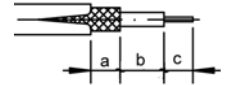
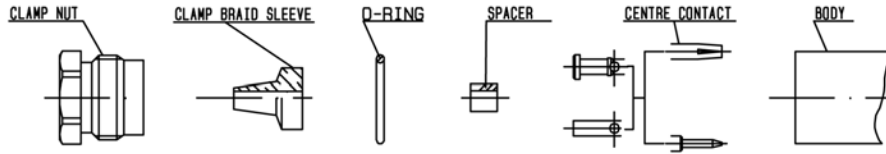

Part Number	Stripping length (mm)			Recommended coupling torque
	a	b	c	
R141 003 000	R141 254 000	R141 323 000		450 N.cm
R141 004 000	R141 277 000	R141 324 000	2	
R141 154 000	R141 278 000		3	
R141 253 000	R141 304 000	R142 154 000	4	

- 1**
- Slide clamp nut onto cable.
 - Strip the cable.
 - Cut the jacket (2 slots) apart if necessary.

- 2**
- Slide the clamp braid sleeve between cable dielectric and braid.
 - Cut the braid flush with the clamp braid sleeve.
 - Slide the spacer.

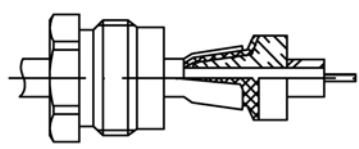

- 3**
- Solder the cable inner conductor into centre contact.
 - Slide the back nut over the clamp assembly.

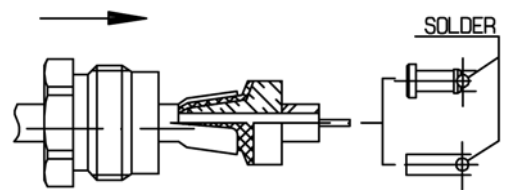

- 4**
- Mount the gasket into the connector.
 - Screw sub-assembly into the connector body.

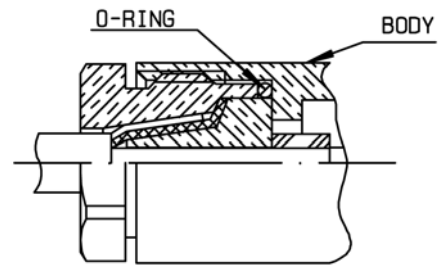

M 03

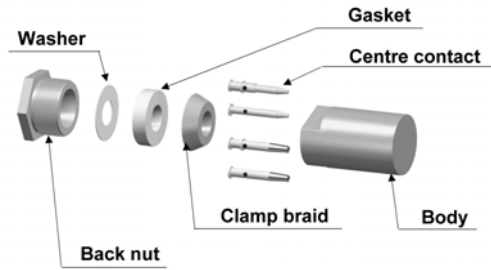

STRIPPING DIMENSIONS

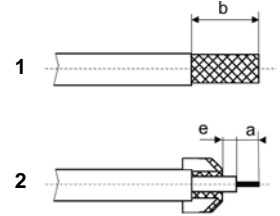

Part Number	Stripping length (mm)			Recommended coupling torque
	a	b	e	
R141 007 161 R141 256 000	2.5	3	7	450 N.cm
R142 016 161		7	3	
R142 017 000	3	3.5	10	

- 1**

 - Strip the cable as shown in sketch 1.
- 2**

 - Slide the clamp nut, the washer and the gasket onto the cable.
 - Slide the clamp braid sleeve over the braid.
- 3**

 - Fold the braid back and trim off the extra braid.
 - Trim dielectric back as shown in sketch 2.

- 4**

 - Slide the back nut over the cable assembly.
- 5**

 - Solder the centre contact onto the inner conductor.
- 6**

 - Screw sub-assembly into the connector body with the adapted wrench.
 - Recommended coupling torque (see table).

M 04

STRIPPING DIMENSIONS

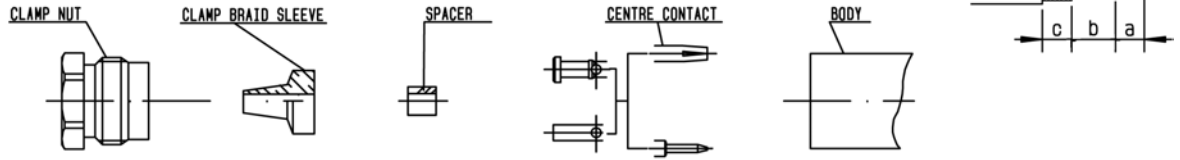

Part Number	Stripping length (mm)			Recommended coupling torque
	a	b	c	
R142 004 000	4	3	2	40 N.cm
R142 202 000	3.5	3.5	1	

1

- Slide clamp nut onto cable.
- Strip the cable.
- Cut the jacket (2 slots) apart if necessary.

2

- Slide the clamp braid sleeve between cable dielectric and braid.
- Cut the braid flush with the clamp braid sleeve.
- Slide the spacer.

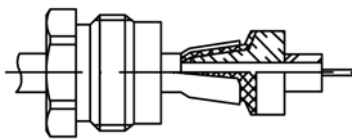

3

- Solder the cable inner conductor into centre contact.
- Slide the back nut over the clamp assembly.

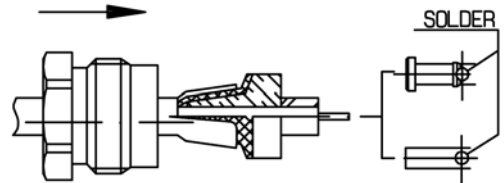

4

- Mount the gasket into the connector.
- Screw sub-assembly into the connector body.

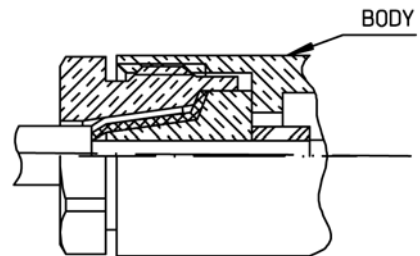

M 05

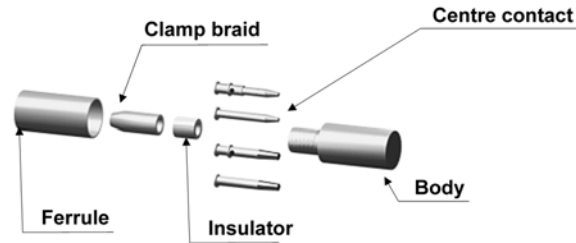

STRIPPING DIMENSIONS

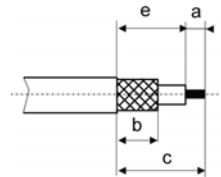

Part Number	Stripping length (mm)				Hex.	Ferrule		Center contact	
	a	b	c	e		Standard crimp tools Dies included	MIL standard R282 293 000 (M22520/5-01) + Dies	Standard crimp tools Dies included	MIL standard R282 293 000 (M22520/5-01) + Dies
R141 075 000 R141 217 000 R141 301 000 R142 076 000 R142 076 161 R142 217 000	4	10	18.5	14.5	1.73 - 5.4	R282 223 000	R282 235 01 (M22520/5-11)	R282 223 000	R282 235 011 (M22520/5-11)
R141 306 000 R141 331 500 R142 331 011				1.73 - 6.48					R282 235 013 (M22520/5-13)

1

- Slide the ferrule onto the cable.
- Strip the cable.

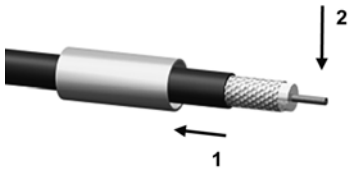

2

- Fan the braid.
- Slide the braid clamp and the insulator between the dielectric and the braid.
- Slide the insulator between the dielectric and the braid.

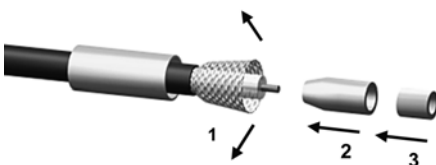

3

- Slide on the centre contact until it bottoms against the cable dielectric.
- Solder or crimp the centre contact with crimping tool (see table).
- Clean solder area if necessary.



4

- Slide cable into body until it bottoms against insulator.

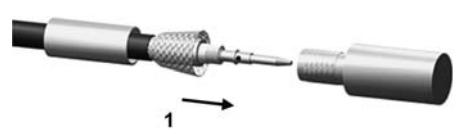

5

- Slide the ferrule over the braid.



6

- Crimp the ferrule with crimping tool (see table).
- Cut the excess of braid if necessary.

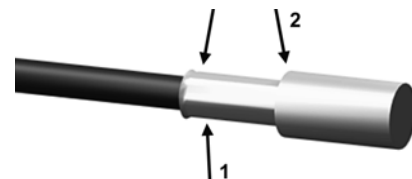

M 06

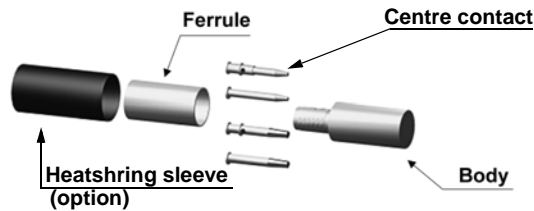

STRIPPING DIMENSIONS

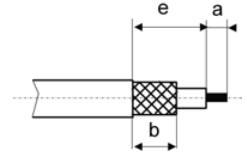

Part number	Stripping length (mm)			Hex.	Ferrule		Center contact	
	a	b	e		Dies included	MIL standard R282 293 000 (M22520/5-01) + Dies	Dies included	MIL standard R282 293 000 (M22520/5-01) + Dies
R141 082 000 R141 292 000 R141 082 161 R141 308 000 R141 083 000 R141 332 161 R141 182 000 R141 332 500 R141 183 000	4	11	8.5	1.73	R282 223 000	R282 235 011 (M22520/5-11)	R282 223 000	R282 235 011 (M22520/5-11)
5.4								
1.73			R282 235 013 (M22520/5-13)	R282 235 013 (M22520/5-13)				
6.48								
R141 220 000 R141 237 161 R142 085 000 R142 184 000 R142 086 161	2.5	9	1.73	R282 231 000	R282 235 116 (Y116 DANIELS)	R282 235 011 (M22520/5-11)		
10.54								
R142 242 000 R142 242 161	4	8.5	5.4	R282 223 000	R282 235 011 (M22520/5-11)	Crimp tool R282 281 000 Positioner R282 968 000 Selection 8		
R142 095 000 R142 295 000 R142 295 161								
R142 083 000	4	8.5	5.4	R282 223 000	R282 235 011 (M22520/5-11)	Crimp tool R282 281 000 Positioner R282 968 000 Selection 8		

- 1 - Slide the heatshrink sleeve onto the cable (Option).
- Slide the ferrule onto the cable.
- Strip the cable.
-
- 2 - Slide the centre contact on until it bottoms against the cable dielectric.
- Crimp the centre contact with crimping tool (see table).
-
- 3 - Fan the braid.
-

- 4 - Slide the cable into the body until it bottoms against insulator.
-
- 5 - Slide the ferrule over the braid.
- Crimp the ferrule with crimping tool (see table).
-
- 6 - Cut the excess of braid if necessary.
- Slide the sleeve over the ferrule and heatshrink it in place (Option).
-

M 07

STRIPPING DIMENSIONS

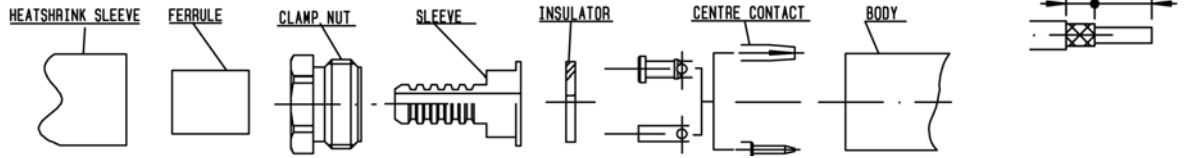

Part number	Stripping length (mm)		Hex.	Crimp tools		Center contact	Recommended coupling torque
	a	b		Dies included	MIL standard R282 293 000 (M22520/5-01) + Dies		
R141 297 000	14	9	5.4	R282 223 000	R282 235 011 (M22520/5-11)	Selection N°7	170 N.cm

- 1**

 - Slide onto cable the ferrule and the heatshrink sleeve.
 - Strip the cable.

3

 - Mount the sub-assembly into the main body and screw the clamp nut.
 - Slide sleeve over the ferrule and heatshrink it in place.

- 2**
- Fan the braid
 - Slide the sleeve over the clamp nut.
 - Slide the braid on the sub-assembly.
 - Slide the ferrule over the clamp nut (in direction F).
 - Crimp the ferrule.
 - Cut the excess of braid.
 - Mount the insulator against the sleeve.
 - Mount center contact against the insulator.
 - Crimp the center contact.

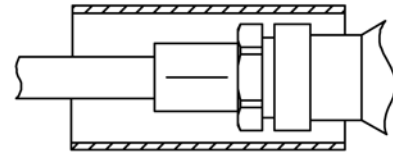
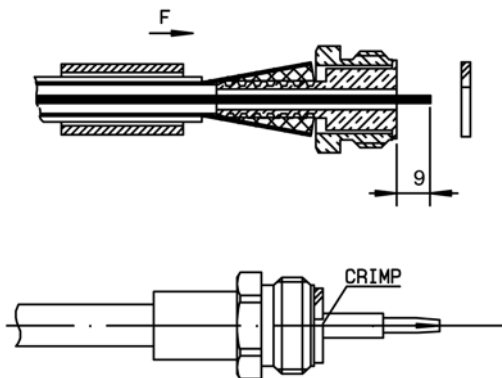

M 08

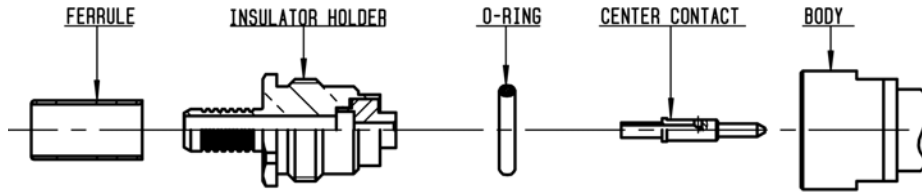

STRIPPING DIMENSIONS

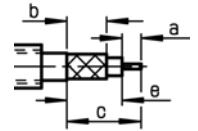

Part number	Stripping length (mm)				Hex.	Ferrule		Recommended coupling torque
	a	b	c	e		Standard crimp tools Dies included	MIL standard R282 293 000 (M22520/5-01) + Dies	
R141 072 000	7	8.5	26	19	5.41	R282 223 000	R282 235 011 M22520/5-11	450 N.cm

1

- Slide the ferrule onto the cable.
- Strip the cable.

2

- Fan the braid.
- Slide the insulator holder under the braid.
- Slide the ferrule onto the cable braid in F direction.

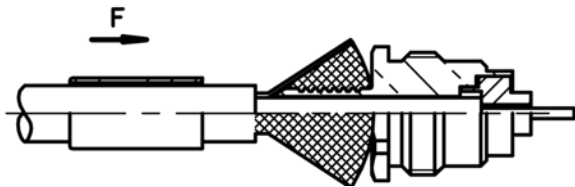

3

- Crimp the ferrule with the crimping tool R282 223 000 (Hex : 5.41) or R282 293 000 (M22520/5-01) + dies R282 235 011 (M22520/5-11).
- Crimp or solder the center contact.
- Put the O-ring onto the insulator holder.

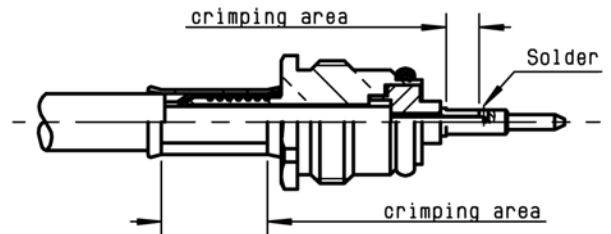

4

- Screw this assembly into the connector body. Recommended coupling torque (450 N.cm).

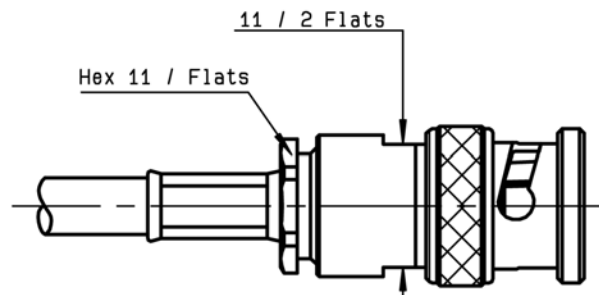

M 09

STRIPPING DIMENSIONS

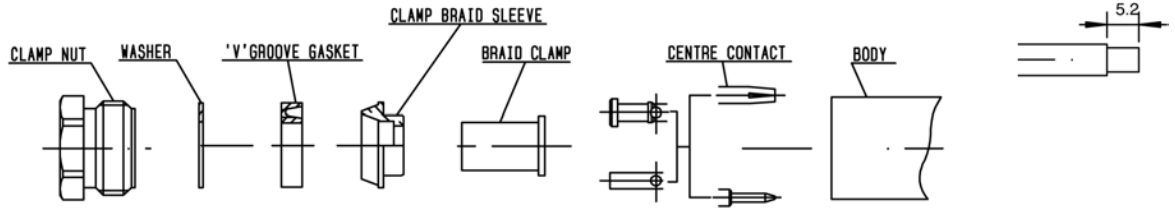

Part number	Recommended coupling torque
R141 052 000	400 N.cm

1

- Strip the cable.

2

- Slide the clamp nut, the washer and the «V» groove gasket onto the cable.
- Slide clamp braid sleeve over braid.
- Slide braid clamp over the braid.
- Trim back dielectric as shown.

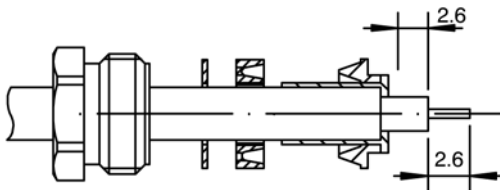

3

- Solder the cable inner conductor into centre contact.
- Solder the braid clamp onto the cable.

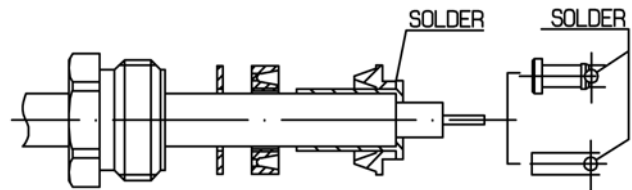

4

- Screw sub-assembly into the connector body.

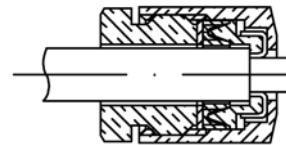

M 10

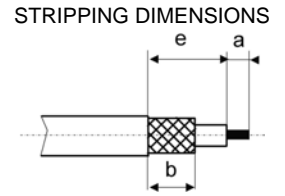
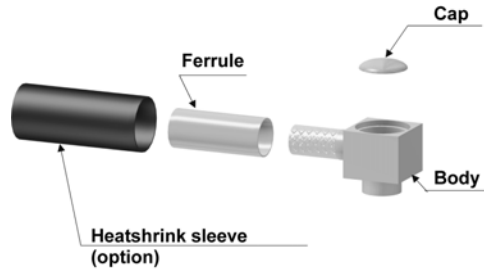

Part Number	Stripping length (mm)			Hex.	Crimp tools	
	a	b	e		Dies included	MIL standard R282 293 000 (M22520/5-01) + Dies
R141 181 161	2.5	7.5	14	6.48	R282 223 000	R282 235 013 (M22520/5-13)
R141 182 161	2	6.5	13.5	3.25	R282 211 000	R282 235 003 (M22520/5-03)
R142 184 161	2	7.5	14	5.41	R282 223 000	R282 235 011 (M22520/5-11)

- 1**
- Slide the heatshrink sleeve onto the cable (Option).
 - Slide the ferrule onto the cable.
 - Strip the cable.

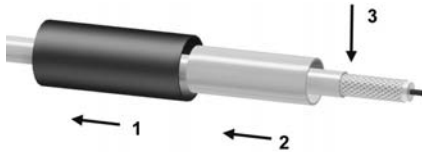

- 2**
- Fan the braid.



- 3**
- Push the connector body under the braid.
 - Slide the ferrule over the braid.



- 4**
- Crimp the ferrule with crimping tool (see table).
 - Solder the inner conductor.

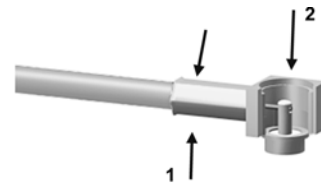

- 5**
- Place the cap into the body.

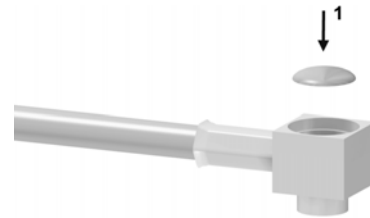

- 6**
- Press on the cap flush or slightly below the surface of the body assembly.
 - Slide the sleeve over the ferrule and heatshrink it in place (Option).

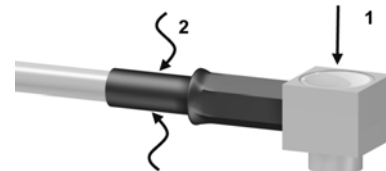

M 11

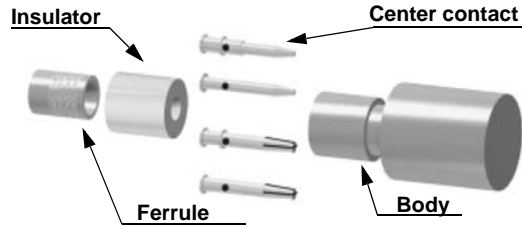

STRIPPING DIMENSIONS

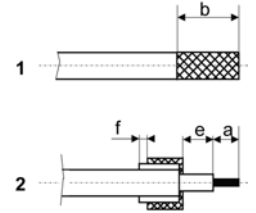

Part number	Stripping length (mm)				Hex.	Center contact		Ferrule	
	a	b	e	f		Dies Included	MIL standard R282 293 000 (M22520/5-01) + Dies	Dies Included	MIL standard R282 293 000 (M22520/5-01) + Dies
R141 290 200	3	8.4	3.4	1.5	1.73-4.5	R282 211 000	R282 235 009 (M22520/5-09)	R282 223 000	R282 235 009 (M22520/5-09)
R141 306 503		10	5		1.73-4.52	R282 223 000	R282 235 011 (M22520/5-11)	R282 211 000	
R142 306 500					1.73-4.5	R282 211 000	R282 235 009 (M22520/5-09)	R282 223 000	R282 235 011 (M22520/5-11)
R142 306 503									
R142 306 520									

- 1**
- Strip the cable as shown in sketch 1.
 - Slide the ferrule until it bottoms against the sleeve.

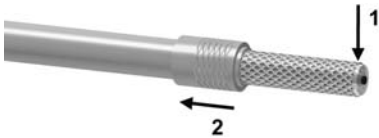

- 2**
- Fold the braid back.
 - Trim off the extra braid as shown in sketch 2.

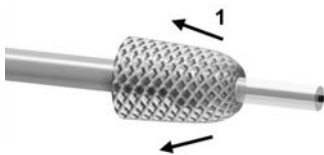

- 3**
- Trim the inner conductor as shown in sketch 2.
 - Slide insulator onto cable dielectric.



- 4**
- Slide the center contact on until it bottoms against the insulator back nut.
 - Solder or crimp the contact with crimping tool (see table).



- 5**
- Mount the body onto the sub-assembly.



- 6**
- Crimp the body with crimping tool (see table).

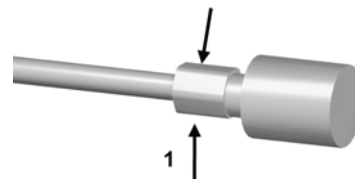

M 12

Insertion procedure

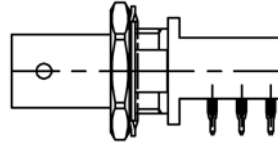

Part number
R141 684 130

1

- Slide the flat tool into the machine (press).

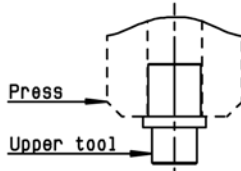

2

- Push on the top (about 500 N) until total insertion (in direction F) (push connector body until it bottoms against PCB).
- Remove the connector and the PCB assembly.

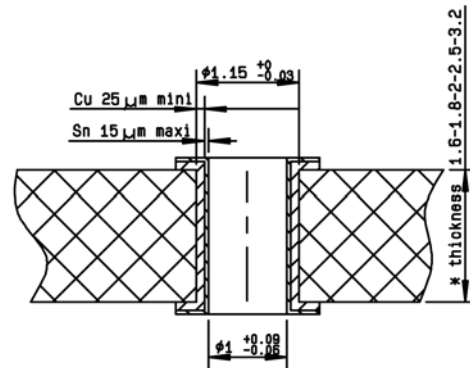
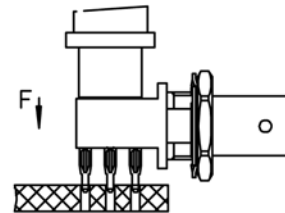

PC BOARD MATERIAL	GLASS FIBRE EPOXYD NEMA : G10, G11, FR4, FR5, DIN 40802 : EP-GC 01, EP-GC 02
HOLE	FOR 1 mm COMPLIANT PIN

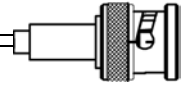

M 13

Insertion procedure

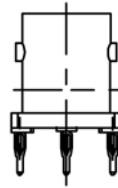

Part Number	Upper tool	Lower tool
R141 416 000	R282 878 240	R282 878 524

- 1** - Slide the upper tool (look at upper tool board) into the machine (press) or the flat tool.
- 3** - Place correctly the right angle connector with press-fit termination on the PCB and introduce the press-fit extremity in the holes of the PCB.

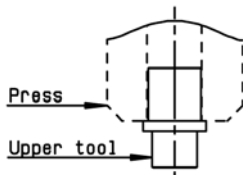

- 2** - Slide the lower tool into the base and place correctly the PCB on this tool (positioning pins).

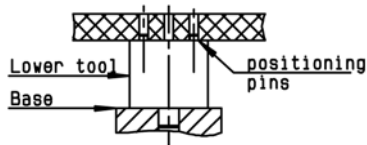

- 4** - Push o the top (about 500 N) until total insertion (in direction F) (push connector body until it bottoms against PCB).
- Remove the connector and the PCB assembly.

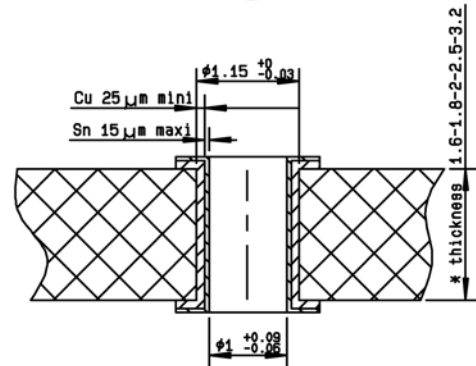
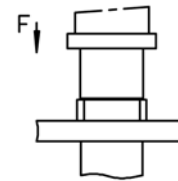
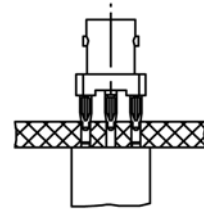

PC BOARD MATERIAL	GLASS FIBRE EPOXYD NEMA : G10, G11, FR4, FR5, DIN 40802 : EP-GC 01, EP-GC 02
HOLE	FOR 1 mm COMPLIANT PIN

M 13

Extraction procedure

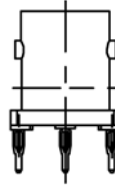

Part number	Upper tool	Lower tool
R141 416 000	R282 878 514	R282 878 534

- 1** - Place correctly the PCB and the connector on lower tool.
- 3** - Press the pack of the upper tool to remove the connector (about 500 N) into the connector slide down onto lower tool.

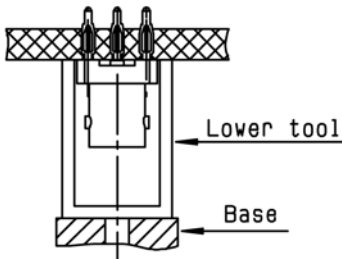

- 2** - Place the upper tool at the back of the connector and place correctly the ejectors :
- on press-fit pins (if PCB thickness < 4.5 mm),
 - in the holes of the PCB (if PCB thickness > 4.5 mm).

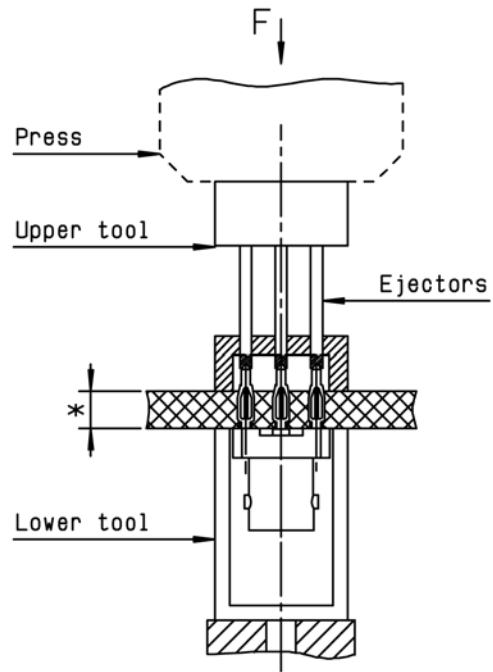

CAUTION !

It's impossible to use a COAXIPRESS a twice.
A plated hole of the PCB can't be used over 3 times.

* panel thickness : 1.6 to 7 mm.

M 14

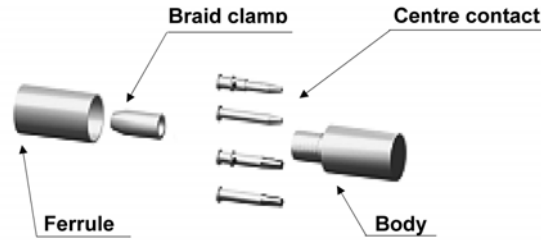

STRIPPING DIMENSIONS

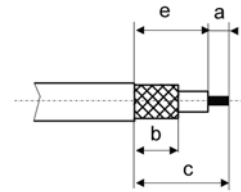

Part number	Stripping length (mm)				Hex.	Center contact		Ferrule	
	a	b	c	e		Dies Included	MIL standard R282 293 000 (M22520/5-01) + Dies	Dies Included	MIL standard R282 293 000 (M22520/5-01) + Dies
R142 078 161	4	10.5	17.5	13.5	1.73 - 6.48	R282 223 000	R282 235 011 (M22520/5-11)	R282 223 000	R282 235 013 (M22520/5-13)

1

- Slide the ferrule onto the cable.
- Strip the cable.

2

- Fan the braid.
- Slide the braid clamp between the dielectric and the braid.

3

- Slide on the centre contact until it bottoms against the cable. Crimp the centre contact with crimping tool.

4

- Slide cable into body until it bottoms against insulator.

5

- Slide the ferrule over the braid.

6

- Crimp the ferrule with crimping tool.
- Cut the excess of braid if necessary.